

permascreed[®]

Mastic Asphalt Screed

NO NEED FOR A SEPARATE
AIR AND VAPOUR CONTROL LAYER

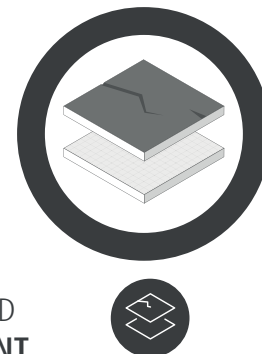
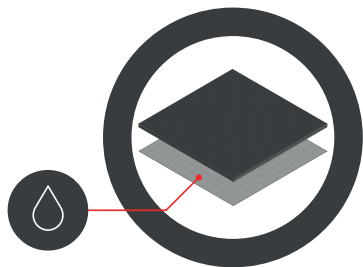

IDEAL FOR BOTH
**NEW BUILD AND
REFURBISHMENT**

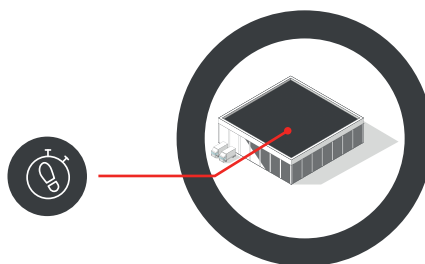

FAST APPLICATION - **TRAFFICABLE
WITHIN THE SAME DAY**



Screeding Solution for Flat Roofs, Walkways and Vehicle Decks



What is IKO Permascreed?

IKO Permascreed is manufactured from selected bitumen, limestone filler and specially graded aggregates. It can be installed to create drainage falls, level out uneven substrates, and provide a stable base for the specified roof/deck waterproofing/surfacing system.

Its special mastic asphalt formulation delivers a fast cooling screed which is trafficable within the same day, making it much quicker than traditional screeds. As a result, delays to other trades are minimised and maximum efficiency can be achieved with quicker project completions.



THERE IS **NO MOISTURE** WITHIN IKO PERMASCREED



THERE IS **NO NEED TO WAIT** FOR IT TO DRY...

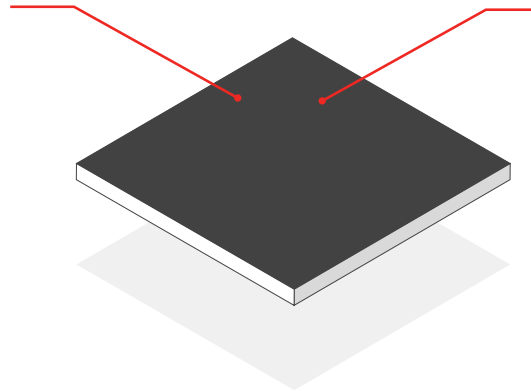

FAST COOLING TIME (TRAFFICABLE WITHIN THE SAME DAY)



COMPATIBLE WITH A RANGE OF FLAT ROOFING AND SURFACING SYSTEMS

SUITABLE FOR USE ON:		COMPATIBLE WATERPROOFING SYSTEMS
Cold roofs	Balcony / terrace applications	Mastic Asphalt
Insulated warm roofs	Walkways / footbridges	Hot Melt
Inverted insulated roofs	Car park / HGV service decks	Liquid Coatings
Green roofs	Podium decks	Single-Ply Membranes
		Reinforced Bitumen Membranes

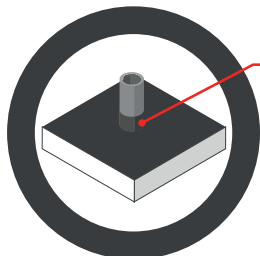

EASILY WORKED AROUND PROTRUSIONS

UNAFFECTED BY LOW AMBIENT TEMPERATURES

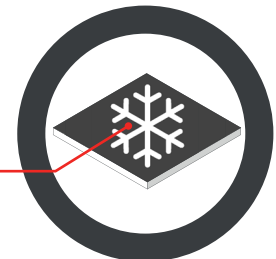

A Faster Alternative to Wet Screeds

Fast-track and versatile screed for levelling or creating drainage falls

FEATURES AND BENEFITS	IKO PERMASCREED	CONCRETE (SAND & CEMENT) SCREEDS
Fast cooling time, avoiding extended drying periods	✓	X
Trafficable within the same day	✓	X
Down to 10mm thickness	✓	X
Can provide an effective air and vapour control layer	✓	X
Carbon Neutral (CarbonZero initiative)	✓	X
Can reduce screed thicknesses by up to 80%	✓	X
Reduces the total weight of the roof system	✓	X
Can provide temporary waterproofing	✓	X
Ideal for both refurbishment and new build projects	✓	X
Creates a range of drainage falls in line with BS 6229:2018	✓	✓
Used with most flat roof types and waterproofing systems	✓	✓
Suitable for levelling uneven substrates	✓	✓
No compaction required	✓	✓
Easily worked around protrusions	✓	✓
Durability of the design life of the building	✓	✓
Suitable for use as a working platform	✓	✓

Installation time - IKO Permascreed vs. Concrete Screeds

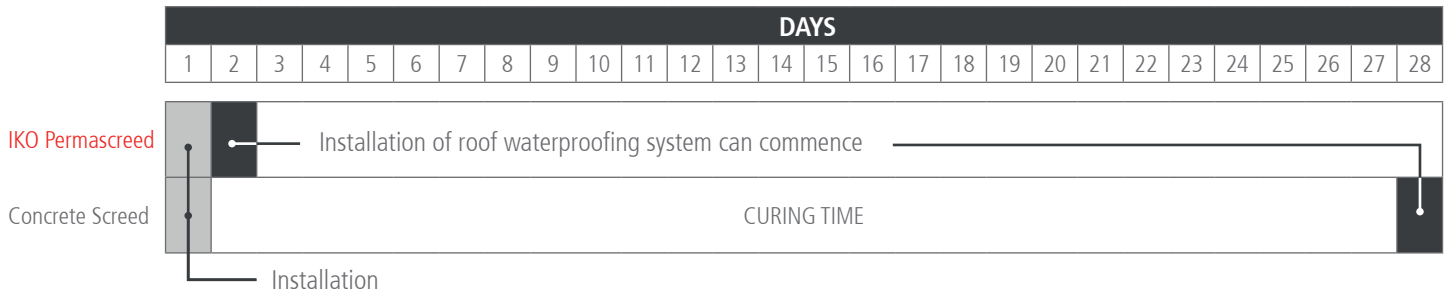

Can IKO Permascreed be used as a Air and Vapour Control Layer?

Yes, in warm roof systems, a minimum 13mm thick layer of IKO Permascreed laid on IKO Glass Fibre Tissue separating layer will provide an effective Air and Vapour Control Layer (AVCL).

Temporary Waterproofing

IKO Permascreed is completely voidless and impervious to water. Therefore it can be used to provide a fast, temporary waterproofing solution prior to the primary waterproofing being installed. Allowing the fitting out of the building to commence much earlier.

Drying Time

IKO Permascreed cools quickly and can be tracked within the same day. Therefore the following waterproofing surfacing can be installed without a delay.

Three IKO Permascreed Grades

DESCRIPTION & PRODUCT CODE BLACK / HOT CHARGE	TYPICAL THICKNESS OF INDIVIDUAL LAYER	USAGE
IKO Permascreed L (Light Duty) 44220000 / 5422000A	10 - 25mm	Roofs, Balconies, Walkways
IKO Permascreed M (Medium Duty) 44200000 / 54200000	20 - 40mm	Roofs, Balconies, Walkways
IKO Permascreed H (Heavy Duty) 44210000 / 54210000	35mm + (max single coat thickness of 60mm)	As above plus Car Parks & HGV Service Decks

Approximate Coverage

THICKNESS	M ² / TONNE
10mm	40
15mm	30
20mm	20
25mm	16
30mm	13
35mm	11
40mm	10
45mm	9
50mm	8
55mm	7
60mm	6.5

Sustainability

IKO Permascreed is manufactured in the UK at our own facility in Grangemill, Derbyshire.

The production process is modern, clean and controlled using carefully blended raw materials. IKO Permascreed contributes to the sustainability of every project through the CarbonZero offsetting programme making it carbon neutral.

Achieving the environmental standards ISO 14001 (environmental management) and BES 6001 (responsible sourcing) are increasingly required major projects.

IKO continue to focus on recycled raw materials, reducing packaging, cutting energy and water consumption and monitoring logistics to minimise environmental impact.

Visit our website to see how IKO are actively achieving corporate social responsibility. www.ikogroup.co.uk

The Installation Process

Sold 'off the shelf' or as part of a bespoke service, IKO Permascreed is the ideal solution

- 1 For smaller screeding projects IKO Permascreed is cast into nominal 20kg blocks, cooled, palletised and wrapped ready for distribution. It is then re-melted on site, for installation.
- 2 For larger projects, IKO Permascreed is loaded directly into IKO's hot charge vehicles. The product is constantly agitated in transit to ensure it is ready to lay on arrival at site.

It is then transferred from the hot charge vehicles into IKO luggers, or other suitable vessels which are driven or lifted to the point of installation.

Whether creating drainage falls or levelling out uneven substrates, large areas can be covered in a single day.

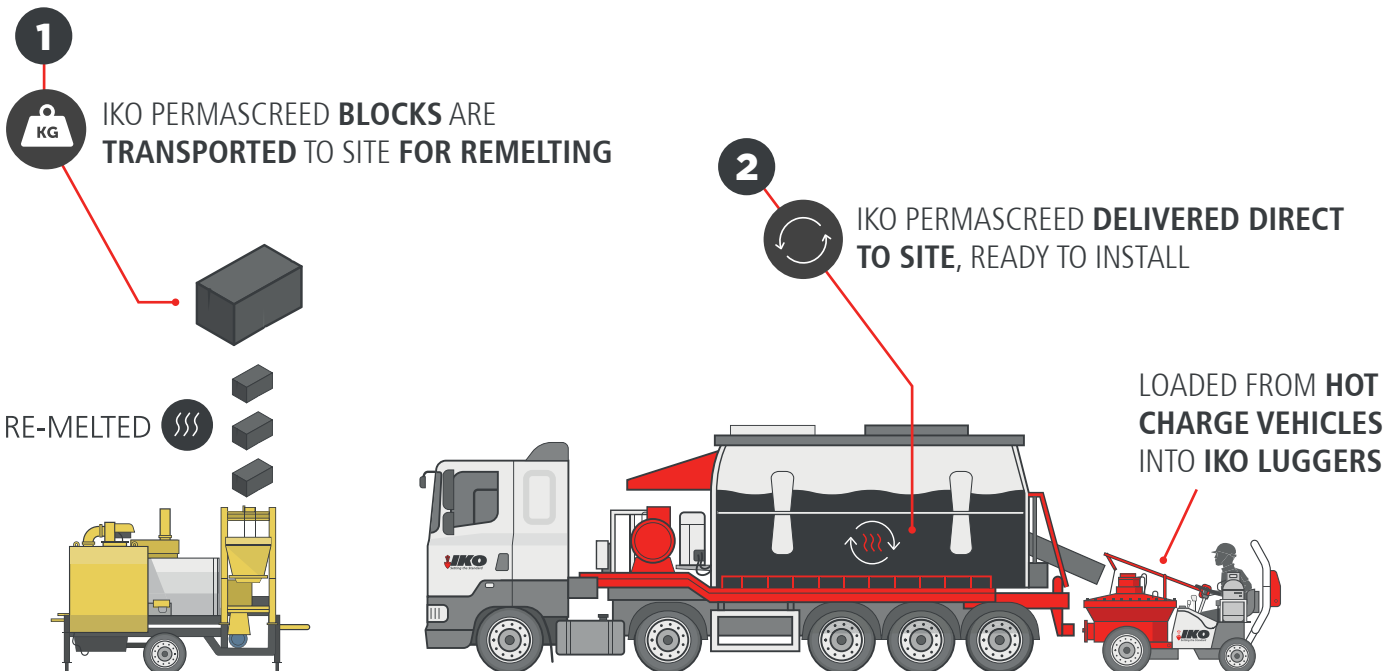

The CarbonZero Effect

We're reducing the impact on our environment



Mastic Asphalt, the ultimate base for production and waterproofing, became the first industry in the world to achieve the CarbonZero standard. This is accomplished by working with CO²balance offsetting the CO² produced during the manufacturing process and purchasing Carbon Credits.

Every tonne of mastic asphalt we make helps to fund environmental and humanitarian causes. In particular, the money raised helps less fortunate people in countries such as Africa where CO²balance is used for providing special brick stoves and borehole rehabilitation for cleaner cooking and water facilities.

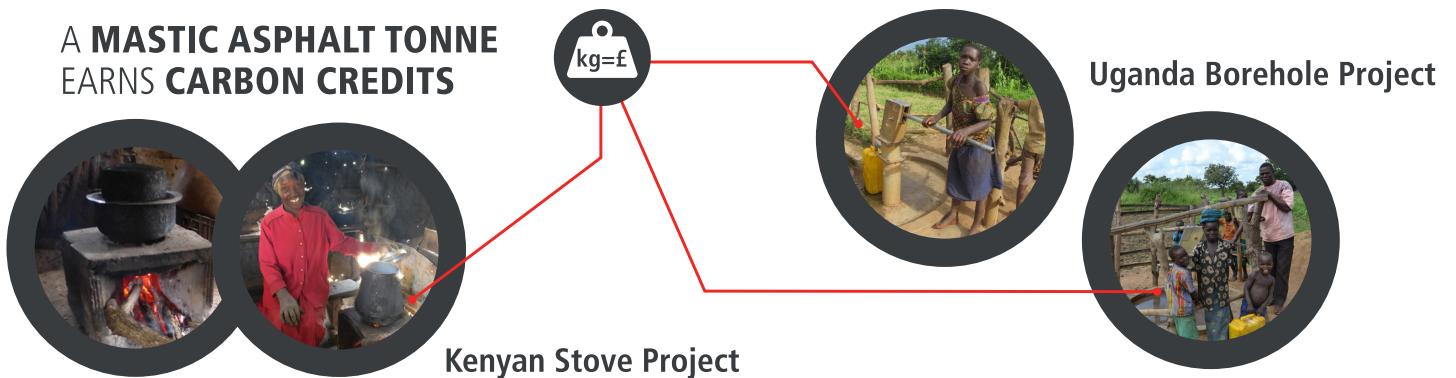

IKO Grangemill

Grangemill, Matlock, Derbyshire DE4 4BW
t: 01257 255 271 / f: 01257 256 889 / info@iko.co.uk

Technical Services

t: 01257 256 888 / technical.uk@iko.com

www.ikogroup.co.uk

September 2020

Whilst every care is taken to see that the information given in this literature is correct and up to date it is not intended to form part of any contract or give rise to any collateral liability, which is hereby specifically excluded. Intending purchasers of our materials should therefore verify with the company whether any changes in our specification or application details or otherwise have taken place since this literature was issued.

