

CROMAR®

Building Products



Product Guide

Sales Director

Daniel Marshall
 Tel: 07770 514 111
 Email: daniel@cromar.uk.com

Internal Sales Support

Kim Knowlson
 Tel: 07957 245 545
 Email: kim.knowlson@cromar.uk.com

Area: **Scotland**
 Name: Ali Adams
 Tel: 07539 160416
 Email: Ali.Adams@cromar.uk.com

Area: **Ireland - West**
 Name: Niall McCarthy
 Tel: 00353(0) 83 0102991
 Email: niall@cromar.ie

Area: **Yorkshire / North**
 Name: Gareth Kitchen
 Tel: 07794 363 027
 Email: garethkitchen@cromar.uk.com

Area: **Yorkshire / North (AlphaChem)**
 Name: Jake Senior
 Tel: 07903 155 629
 Email: jake@cromar.uk.com

Area: **North West**
 Name: Conrad Henderson
 Tel: 07903 155 612
 Email: conrad.henderson@cromar.uk.com

Area: **Midlands**
 Name: Danny Wall
 Tel: 07929 607 078
 Email: danny.wall@cromar.uk.com

Area: **South West**
 Name: John Bain
 Tel: 07747 136 869
 Email: john.bain@cromar.uk.com

Area: **South East**
 Name: Grahame Wratten
 Tel: 07812 582 656
 Email: grahame@cromar.uk.com

Area: **London & South East**
Business Development Manager
 Name: Rachel Stamps
 Tel: 07494 488 893
 Email: rachel.stamps@cromar.uk.com



Training Team

John Watts
 Area: **North**
 T: 07432 020 119
 E: john.watts@cromar.uk.com

Ali Adams
 Area: **Scotland**
 T: 07539 160 416
 E: Ali.Adams@cromar.uk.com

Richard Boyd
 Lead trainer
 T: 07496 823 875
 E: richard@cromar.uk.com

Jonathon Kelly
 Area: **South**
 T: 07538 423 924
 E: Jonathon.kelly@cromar.uk.com

Jason Smedley
 Area: **North**
 T: 07943 722 313
 E: jason.smedley@cromar.uk.com



For more information, sales and technical support please contact us on:

Tel: 01977 663 133
 Fax: 01977 662 186
 Email: sales@cromar.uk.com
 Customers Services: CustomerServices@cromar.uk.com

Technical Queries

If you have a technical question on any of the products in this catalogue please refer to the FAQ section on the website or contact the relevant specialist on the below numbers:

Technical Manager - Richard Boyd: 07496 823 875
AlphaChem Technical- Jake Senior: 07903 155 629



The Cromar range has grown rapidly since the company started in 1997, with just a core range of 10 products. From that point onwards we have added many more products into the Cromar brand and are proud to be able to offer a one stop shop for all flat and pitched roofing products. So whether it's the more traditional torch on felts, a glassfibre roofing system or lead replacement systems you will find them all in the Cromar range.

Contents

Flat Roofing

Flexiglass®	4-5
PROGRP®	6-7
TechSeal	8-9
GRP Trims	10-11
Hydrosil®	12
Cromapol®	13
Bitumen Products	14
Rubber Coat	15
Acrypol, Quartz Dek & Metal Kote	16-17
Traditional Felts	18-19

Pitch Roofing

Vent3® Range	20-21
Leadax & Lead replacements	22-23
PRO Ridge	24
GRP Valleys	25
Cromaslate	26-27
Roofing Accessories	28-30

AlphaChem® Range	32-47
-------------------------	--------------

Flexiglass[®] 2022

GRP Multi Surface Overlay System



Acrypol Flexiglass is a versatile GRP resin roof system designed for new and existing roofs. Flexiglass can be applied to almost any roof surface such as felt, asphalt, concrete and OSB3 TG board as a new roof covering. Flexiglass is a totally seamless, highly flexible roof system ideal for any sized job.



Flexible GRP for all types of common roofing substrates

One resin for both Base & Topcoat

Quick cure Primer

Uses a 225G Chopped Strand Matting for the ultimate in flexibility

Health & Safety conscious Catalyst with easy application

Suitable for both new decks & refurbishment projects

Superior Adhesion

Unaffected by direct sunlight



Visit our website for more info.



Flexiglass Resin.

A pre-promoted thixotropic polyester flexible resin designed specifically for overlay roofing applications.

Prod. Code	Size	Pallet Qty
G20/FLEXITC20	20kg	36



Flexiglass Primer.

Pre-promoted, low viscosity, Thixotropic, polyester flexible primer designed specifically for overlay roofing application enabling an outstanding bond to multiple substrates.

Prod. Code	Size	Pallet Qty
G20/FLEXIPRIMER5	5kg	120



Flexiglass Catalyst.

Catalyst is the primary component of any fibreglass flat roofing system

Prod. Code	Size	Box Qty
G20/BP050	50g	250
G20/BP0100	100g	125
G20/BP0200	200g	60

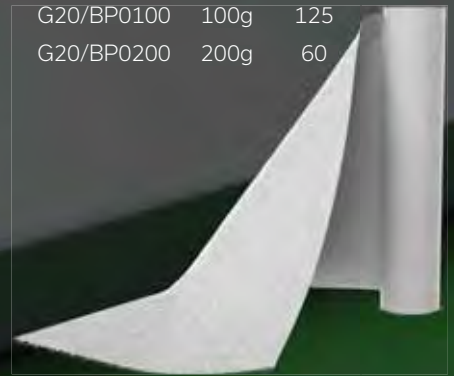

Flexiglass Matting.

Part of the Flexiglass system, the 225gsm fibreglass matting is sandwiched between two layers of Flexiglass resin.

Prod. Code	Size
GMATTECH/225/33	35kg
GMATTECH/225/6.75	6.75kg
GMATTECH/225/16.5	16.5kg



GRP Trim Adhesive.

Fast curing, grey, polyurethane sealant and adhesive. Excellent chemical, mechanical and weather resistance. Shore A hardness: 40.

Prod. Code	Size	Pallet Qty
MPHM/031	300ml	48



Flexiglass Jointing Bandage.

The jointing bandage is used to tape joints and seams on a Flexiglass roof. The strands of the glassfibre are held together by an emulsion binder to form a mat.

Prod. Code	Description	Size
GMATT/225/BAN	Bandage	50m x 75mm

Become an approved installer.
Visit our training page...



cromarbuildingproducts.com/training

PROGRP®

ADVANCED GLASSFIBRE ROOFING SYSTEM



We have developed this technology further to produce the perfect all weather protection for any flat roof. PRO GRP can be applied in small domestic situations right through to large industrial environments.



Benefits of a GRP System

COLD APPLIED
no heat required

EASY TO FORM
around complex situations

VERY DURABLE
resists heavy foot traffic

NON-SLIP WALKWAYS
can be incorporated

CLASS LEADING ROOFING SOLUTION
that far exceeds traditional methods

VIRTUALLY MAINTENANCE FREE
for very long periods of time

IMPACT RESISTANT
due to its ultra hard finish

FIRE RETARDANT

HIGHLY ECONOMICAL SOLUTION



Visit our website for more info.

TOP TIPS

GRP should be applied at a minimum temperature of 5°C, up to 30°C maximum.



PRO GRP Resin.

Specially formulated resin.

Cold applied and easy to form around complex situations, durable and able to resist foot traffic PRO GRP resin is an essential component in the roofing system.

Prod. Code	Size	Pallet Qty
G25/RES10	10kg	48
G25/25RESIN20	20kg	36



PRO GRP Top Coat.

Speciality Top Coat.

Part of the PRO GRP Roofing System, the top coat is brush or roller applied, cold applied and fully bonds to the roof membrane to form a complete system.

Prod. Code	Size	Pallet Qty
G25/TOP10FR	10kg	48
G25/TOP20FR	20kg	36



PRO GRP Hardener.

Catalyst.

General purpose MEKP gives consistent curing of unsaturated polyester resins and topcoats.

Prod. Code	Size	Box Qty
GH/1	1kg	10
GH/5	5kg	1



PRO GRP Acetone.

Solvent based cleaner.

Solvent used for cleaning tools and areas contaminated with adhesives, polyesters, resins and other similar products.

Prod. Code	Size	Box Qty
GA/1	1ltr	12
GA/5	5ltr	4
GA/25	25ltr	1



Glass Fibre Matting.

High mechanical strength.

Part of the PRO GRP Glassfibre roofing system, the fibreglass matting is sandwiched between two layers of PRO GRP Resin.

Prod. Code	Size	Pallet Qty
GMAT/15	6.5Kg	49
GMAT/16.5	16.5Kg	25
GMAT/35	450gsm 33Kg	12
GMAT/35600	600gsm 33Kg	12



Glass Fibre Jointing Bandage.

Excellent wet strength.

The jointing bandage is used to tape joints and seams on GRP roofs. The strands of the glassfibre are held together by an emulsion binder to form a mat.

Prod. Code	Size	Box Qty
GB/ROLL	100mm	10

GRP 13sqm Kit.

A handy kit containing everything required for a 13 sqm roof.

Prod. Code	Size	Box Qty
GRP/KIT13B	13sqm	1



GRP Finishing Tissue.

The finishing touch.

The finishing tissue is for neat finishes on visible moulded corners and tidying up details on roof penetrations.

Prod. Code	Size	Box Qty
GTISH	100mm x 250m	10



TURN TO PAGE 10 TO FIND OUT ABOUT OUR COMPREHENSIVE RANGE OF TRIMS AND ACCESSORIES

TECHSEAL

High Performance PU Membrane



Tech Seal.

Performance Waterproofing.

Tech Seal PU is a single component, high performing liquid polyurethane membrane that cures to form a tough and seamless durable waterproof coating.

Tech Seal PU is recommended for use on flat roof overlay systems and can be used on traditional built-up roofing in both new construction and refurbishment projects. Its cold applied seamless finish makes it ideal for roofs, green roofs, balconies, terraces, podium decks and gutters and as a detailing product for other roofing systems, including asphalt, bituminous felt, concrete, single ply, and metal surfaces.



Fast Curing

Single Component / No Mixing

Light grey Base Coat / Dark Grey Top Coat

2 Coat System – Fully Reinforced

Easy Application

Application by Roller or Brush or Airless Spray

BBA certified



Visit our website
for more info.





TS Porosity Sealer

Flexible aromatic one-component, moisture cure polyurethane resin for sealing and priming bituminous supports. This resin cures by air moisture giving a flexible coating. It is an excellent polyurethane primer for recoating old bituminous layers with polyurea or polyurethane waterproofing systems.

Prod. Code	Description	Size
ACRY/TSPP4	TS Porosity Primer	4kg



TS PU Primer

PU Activator allows both in the case of waterproofing membranes as well as in floorings, adhesives and other polyurethane coatings, to obtain high adhesion "links" between the substrate and the coating on top, so that there is a chemical anchorage between both elements. Even though PU Activator is a product that by itself it does not offer any film formation or any mechanical properties, (so it is definitely not a product to be used on its own), it does provide extreme adherence in combination with polyurethane products.

Prod. Code	Description	Size
ACRY/TSPUP4	TS PU Activator	4kg



TS Base Coat

A light grey one component liquid semi-thixotropic waterproofing composition, after polymerization gives an elastomeric, cold-applied polyurethane membrane.

Prod. Code	Colour	Size	Plt. Qty
ACRY/TSPLG5	Light Grey	6kg	72
ACRY/TSPLG25	Light Grey	25kg	20



TS Top Coat

A dark grey one component liquid semi-thixotropic waterproofing composition, after polymerization gives an elastomeric, cold-applied polyurethane membrane.

Prod. Code	Colour	Size	Plt. Qty
ACRY/TSDG1	Dark Grey	6kg	72
ACRY/TSPDG25	Dark Grey	25kg	20



Prod. Code	Description	Size
GMATTECH/225/6.75	TS FG Matting	6.75kg
GMATTECH/225/16.5	TS FG Matting	16.5kg
GMATTECH/225/33	TS FG Matting	33kg



Prod. Code	Description	Size
GMATT/225/BAN	Bandage	50m x 75mm

Compatible with



PRO GRP Trims - A.

Drip trims.

A range of drip trims in varying sizes, fitted to the roof edge to allow rainwater drainage to flow into the gutter.

Prod. Code	Size	Box Qty
GA250/RSDT-2	A250	10
GA200/RSDT-1	A200	10
GA170	A170	10

A TRIMS

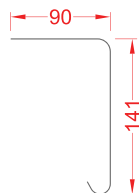

**A250
LARGE DRIP TRIM**

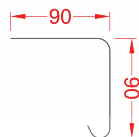

**A200
STANDARD DRIP TRIM**

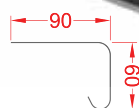

**A170
SMALL DRIP TRIM**

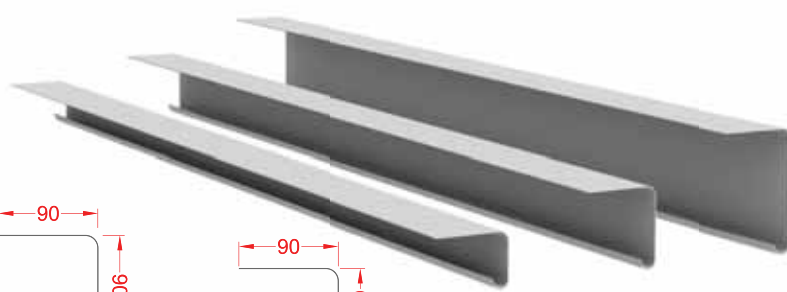

PRO GRP Trims - B.

Raised edge trims.

A range of raised edge trims in differing sizes, fitted to the roof edge to prevent water run off.

Prod. Code	Size	Box Qty
GB/300	B300	10
GB260/RSRT-2	B260	10
GB230/RSRT-1	B230	10

B TRIMS

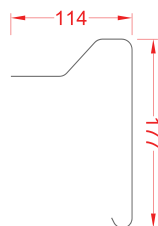

**B300
LARGE RAISED EDGE TRIM**

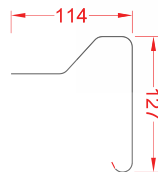

**B260
STANDARD RAISED EDGE TRIM**

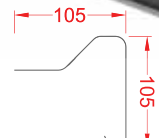

**B230
SMALL RAISED EDGE TRIM**

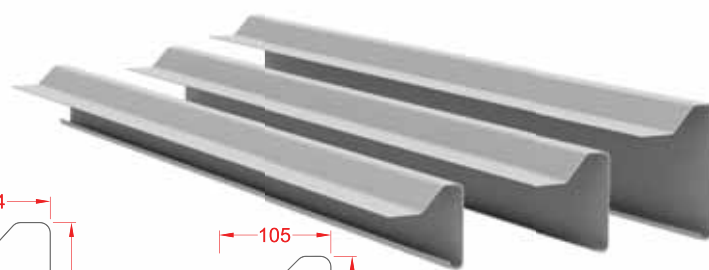

PRO GRP Trims - C,D,E,F.

C - to be used in conjunction with D260 wall fillet.

D - for use against a butting wall or parapet.

E - for creating rolls on ridge details or expansion joints on large roofs.

F - used under slates at a roof junction or as a gutter lining.

C TRIM



**C100
SIMULATED LEAD FLASHING**

D TRIM



**D260
ANGLE FILLET TRIM**

E TRIM



**E280
EXPANSION JOINT /
ROLL MOP TRIM**

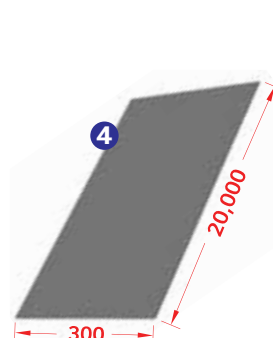
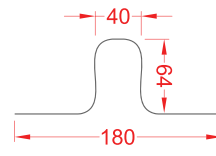
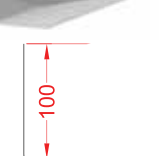
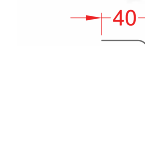

**F300
FLAT SHEET**

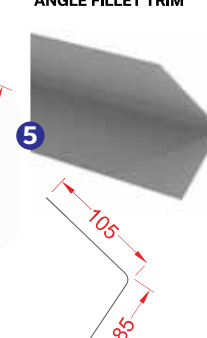

**INT 195
INTERNAL RAISED
ANGLE TRIM**

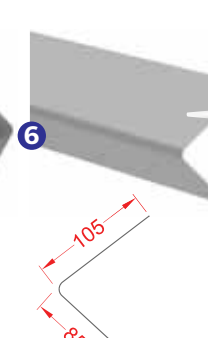

**EXT 195
EXTERNAL RAISED
ANGLE TRIM**

**F300
FLAT SHEET**

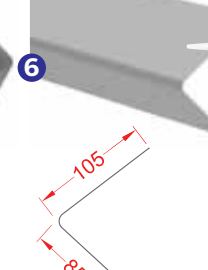
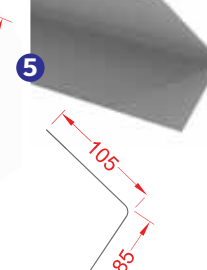
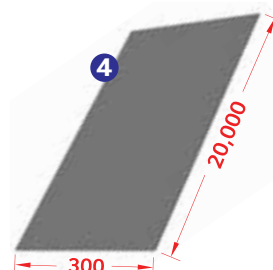

**F300
FLAT SHEET**

**INT 195
INTERNAL RAISED
ANGLE TRIM**

**EXT 195
EXTERNAL RAISED
ANGLE TRIM**

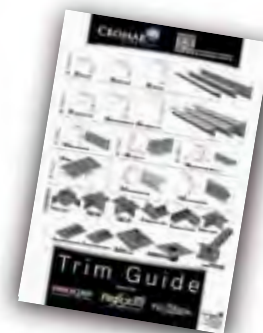

Visit: cromar.uk.com/products-grp-trim-guide/
For our GRP Trim Guide

	Prod. Code	Size	Box Qty
1	GC100/RSLT-1	C100	10
2	GD260/RSAT-1	D260	10
3	GEXP	E280	10

	Prod. Code	Size	Box Qty
4	GF300	F300	1
5	GINT/195.RS/INT	INT 195	10
6	GEXT/195/RS/INT	EXT 195	10



GRP Trim Adhesive.

Fast curing, grey, polyurethane sealant and adhesive. Excellent chemical, mechanical and weather resistance. Shore A Hardness: 40

Prod. Code	Size	Box Qty
MPHM/031	300ml	12

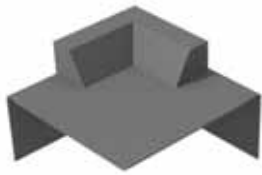

C1
EXTERNAL CORNER

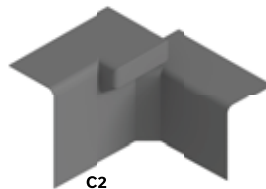

C2
FILLET TO TRIM
CORNER - LEFT

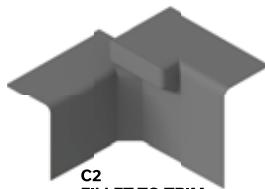

C2
FILLET TO TRIM
CORNER - RIGHT



C3
INTERNAL FILLET CORNER



C3
EXTERNAL FILLET CORNER

PRO GRP Corners.

Pre-formed corners.

Hot press moulded, versatile and long lasting corners, part of the PRO GRP system.

Prod. Code	Size	Box Qty	Prod. Code	Size	Box Qty
GA/C1	C1 INT	1	GA/C3INT	C3 INT	1
GA/C2	C2 Left	1	GA/C3EXT	C3 EXT	1
GA/C2R	C2 Right	1	GA/C4	C4 INT	1

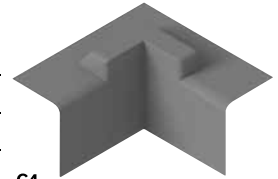

C4
INTERNAL CORNER

PRO GRP Closures.

Roof ridge closures.

Pre-formed closure trims for application to the end of the roof ridge section when using the PRO GRP system - available in small or large sizes.

Prod. Code	Size	Box Qty
GA/C5	C5 Large	1
GA/C6	C6 Small	1

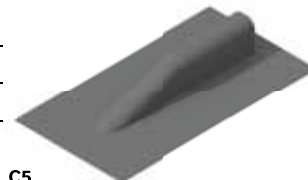

C5
LARGE ROOF RIDGE CLOSURE



C6
SMALL ROOF RIDGE CLOSURE

PRO GRP Outlets.

Roof drainage.

Pre-formed drainage outlets.

Prod. Title	Prod. Code	Box Qty
Pipe Collar Rainwater Outlet	GA/117	1
Through Wall/ Parapet Outlet	GA/7115	1
Rainwater Outlet for Internal Drain	GA/7116	1

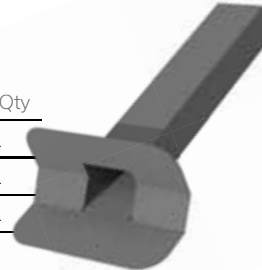

THROUGH WALL
PARAPET OUTLET TRIM

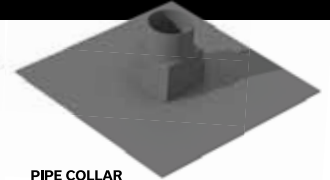

PIPE COLLAR
RAINWATER OUTLET



RAINWATER OUTLET
FOR INTERNAL DRAIN

Rollers.

It's how we roll.

High quality roller and refills - perfect for applying PRO GRP Resin and Top Coat. Much stronger than conventional rollers, they are longer lasting, giving much better results.



Prod. Code	Size	Box Qty
GROLL/3	3" Roller	10
GFILL/3	3" Refill	20
GROLL/7	7" Roller	6
GFILL/7	7" Refill	6
GROLL/9	9" Roller	6
GFILL/9	9" Refill	6

Laminating Rollers.

Bubble busters.

A bubble buster with ribbed metal rollers for eliminating bubbles, helps to ensure an even resin to mat ratio.

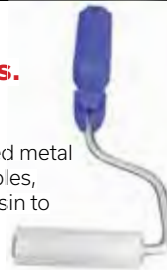

Prod. Code	Size	Box Qty
GBB/70	70mm x 21mm	10
GBB/140	140mm x 21mm	10
GBB/225	225mm x 21mm	10
GBB/225/40	225mm x 40mm	5

Brushes.

High quality brushes.

Laminating brush for the application of PRO GRP Resin, also handy for Top Coat detailing.



Prod. Code	Size	Box Qty
GPB/2	2"	12
GPB/3	3"	12
GPB/4	4"	12

Accessories.

The perfect add on's while using any of our Liquid Roofing System, including mixing buckets, catalyst dispensers, and mixer paddles.



Prod. Title	Prod. Code	Size	Box Qty
White Tub	EMPTY/10	10ltr	1
PROGRP Mixing Bucket	EMPTYGRP/12.5	10ltr	1
NEW! Flexiglass Mixing Bucket	EMPTYFLEXI/12.5	10ltr	1
White Tub	SEMPYTY/501	5ltr	1
Graduating Bucket	GBUCK/10	10ltr	1
Catalyst Dispenser	GDISP/80	80ml	50
ScanGrit	GSCAN/25	25kg	-





Hydrosil Silicone Roof Coating.
The ultimate roof coating .

A high performance, moisture curing liquid applied premium silicone coating. With superior coverage, Hydrosil covers over one and a half times that of a standard PU coating. Fast curing, durable, watertight and weatherproof barrier, excellent UV resistance and foot trafficable in 24 hours are just some of the product benefits.

Prod. Code	Size	Box Qty
AHYDSIL/501	3.78ltr	1
AHYDSIL/601	18.9ltr	1

Hydrosil Seam Sealer & Detailer.
Multi purpose product.

A premium silicone based multi purpose detailer for protection of seams, penetrations and fasteners on various roofing substrates. Forms a durable, breathable and weatherproof barrier that is highly resistant to degradation from UV and natural weathering.

Prod. Code	Size	Box Qty
AHYDSIL/SSD	7.5ltr	1

Hydrosil Reinforcement Roll.
Heavy duty roll.

A non-woven, spun bonded 100% polyester used with the Hydrosil Seam Sealer & Detailer to reinforce seams, penetrations, joints or transitions that are subjected to high shear.

Prod. Code	Size	Box Qty
AHYDSIL/ROLL	150mm x 100m	1

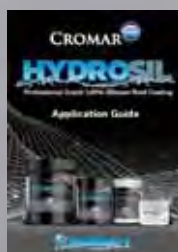

Visit: cromar.uk.com/products/hydrosil-application-guide/

CROMAPOL®

One Coat Instant Waterproofing



Leave Cromapol 72 hours to dry. In summer conditions 24 hours should be ample



Cromapol will waterproof instantly, even while wet, and will not wash off while curing. It is ideal for use in damp conditions. Will withstand ponding and covers in only one coat.

Cromapol. Acrylic Roof Coating.

A one coat, instant waterproof coating ideal for emergency repairs. With the ability to use in damp conditions it provides a flexible, seamless, reinforced membrane that gives instant protection.

Prod. Code	Colour	Size	Box Qty
APOL/1F	Mid Grey	1Kg	12
APOLB/1F	Black	1Kg	12
APOLW/1	White	1Kg	12
APOL/2.5F	Mid Grey	2.5Kg	6
APOLB/2.5	Black	2.5Kg	6
APOLW/2.5	White	2.5Kg	6
APOL/5	Mid Grey	5Kg	4
APOLB/5F	Black	5Kg	4
APOLW/5F	White	5Kg	4
APOL/20	Mid Grey	20Kg	1
APOLB/25	Black	20Kg	1
APOLW/25	White	20Kg	1

Cromapol Fibre Free.

A fibre free, one coat, instant waterproof coating ideal for emergency repairs. With the ability to use in damp conditions it provides instant protection.

Prod. Code	Colour	Size	Box Qty
APOLTR/1	Opaque	1Kg	12
APOLTR/2.5	Opaque	2.5Kg	6
APOLTR/5	Opaque	5Kg	4
APOLWP/5	White	5Kg	4
APOLGP/5	Mid Grey	5Kg	6
APOLTR/20	Opaque	20Kg	1
APOLWP/20	White	20Kg	1
APOLGP/20	Mid Grey	20Kg	1

Reinforcement Scrim. Scrimtex glass fibre scrim.

Used when extra reinforcement is required, for example cracks in corrugated asbestos, gutters, splits in felt and asphalt roofing.

Prod. Code	Size	Box Qty
QSC/50	1m x 50m	1

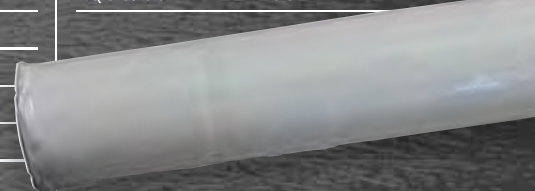

WATERPROOF PROTECTION OF:
Flat and pitched roofs, Corrugated asbestos, Roof lights, Flashing, Roofing felts, Gutters, Slate, Asphalt, Lead, Glasshouses, Metal, Fibreglass

Bitumens

Bitumen roof compounds continue to represent exceptional value for flat roof waterproofing and emergency repairs. Our range covers every possible application.



Bitumen Primer.

General purpose primer.

Low viscosity bitumen primer for use on porous surfaces before any remedial roof treatment, including pour and roll and torch-on felt applications. Quick Drying (QD) version also available.

Prod. Code	Size	Box Qty
APR/101	1ltr	12
APR/251	2.5ltr	6
APR/501	5ltr	4
APR/601	25ltr	1
AQP/501 (QD)	5ltr	4
AQP/601 (QD)	25ltr	1



Roofing Felt Adhesive.

Superior bond technology.

Cold applied, bituminous adhesive for bonding successive layers of roofing felt.

Prod. Code	Size	Box Qty
AFA/101	1ltr	12
AFA/251	2.5ltr	6
AFA/501	5ltr	4
AFA/601	25ltr	1



Black Bitumen Paint.

Waterproofing protection.

A general purpose paint for waterproofing and weather protection of steelwork and concrete.

Prod. Code	Size	Box Qty
ABP/101	1ltr	12
ABP/251	2.5ltr	6
ABP/501	5ltr	4
ABP/601	25ltr	1



Aluminium Paint.

Bright aluminium coating

Bright aluminium reflective coating suitable for application to bituminous roofing substrates. Premium Grade (P) also available.

Prod. Code	Size	Box Qty
AAC/101	1ltr	12
AAC/251	2.5ltr	6
AAC/501T	5ltr	4
AAC/601	25ltr	1
AAP/501 (P)	5ltr	4
AAP/601 (P)	25ltr	1



All Weather Roof Coat.

For general waterproofing.

Filled bitumous solution for overall waterproofing of roofs. Can be applied to dry surfaces all year round.

Prod. Code	Size	Box Qty
AAW/251	2.5ltr	6
AAW/501	5ltr	4
AAW/601	25ltr	1



Cromaprufe.

Cold applied.

General purpose rubberised bitumen emulsion used on walls and floors to prevent water ingress and dampness from the ground. Can also be used on roofs and as wood block floor adhesive.

Prod. Code	Size	Box Qty
ACP/251	2.5ltr	6
ACP/501	5ltr	4
ACP/601	25ltr	1



Cold Gritting Adhesive.

Got grit?

Cold applied bituminous adhesive for bonding chippings to flat or low pitched roofs.

Prod. Code	Size	Box Qty
ACG/501	5ltr	4
ACG/601	25ltr	1



Trowel Mastic.

Fills cracks and gaps.

Heavy body bituminous mastic for sealing cracks and splits in roofing substrates and gutters.

Prod. Code	Size	Box Qty
ATM/101	1ltr	12
ATM/251	2.5ltr	6
ATM/501	5ltr	4
ATM/601	25ltr	1



Roofing Emulsion.

For general waterproofing.

Bituminous emulsion containing fillers which provides all over waterproofing of roofs, leaving a smooth finish.

Prod. Code	Size	Box Qty
ARE/601	25ltr	1

RubberCoat

LIQUID RUBBER ROOF COATING

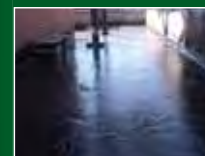
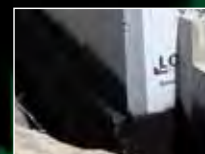

FLEXIBLE HEAVY DUTY LIQUID RUBBER WATERPROOF COATING

- Easy to apply - brush, roller or squeegee
- Flexible seamless technology
- Excellent UV, adhesion & chemical resistance
- Protects & bonds to virtually any surface
- Excellent freeze / thaw resistance
- Resists cracking, chipping, peeling, impact & abrasion

RubberCoat.

Flexible waterproof coating.

A brush/roll on high performance coating that can be applied over many surfaces including concrete, masonry, wood, brick, metal foam and more.

Prod. Code	Size	Box Qty
ARC/3.78	3.78ltr	4
ARC//18.9	18.9ltr	1



ZERO VOC's



ENVIRONMENTALLY SAFE



WATER-BASED

ACRYPOL+

The Original



Instant waterproof protection without wash off

Fibre reinforced seamless membrane

Unaffected by temperature change

Custom developed acrylic resin

Maximum solar reflectivity

Damp weather application

Single coat application

Outstanding adhesion

Excellent flexibility

Indefinite shelf life

Ready to use



Acrypol +.

The original instant waterproof solution for emergency leaks & failing flat roofs.

Acrypol+ is a total roof coating waterproof system developed to refurbish failed industrial, commercial or domestic flat roofs and is also ideal for general property maintenance as well as patch repairs. Brush applied as a semi liquid paste; it dries to form an ultra-tough, seamless flexible overlay. Acrypol + known as the original waterproof coating, can be applied during damp weather conditions and still provide a long-term solution to waterproofing problems, including flat roof repair.

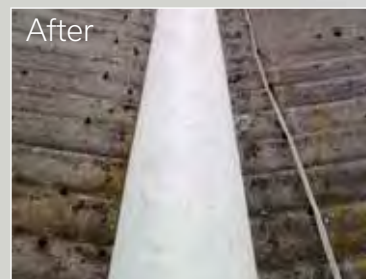
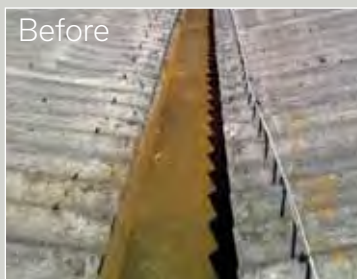

Prod. Code	Colour	Size	Box. Qty
ACRYPOL/2.5	Grey	2.5kg	
ACRYPOL/5	Grey	5kg	4
ACRYPOL/20	Grey	20kg	
ACRY/FSOLW/5	Solar White	5kg	4
ACRY/FSOLW/20	Solar White	20kg	
ACRY/FSOLB/5	Black	5kg	4
ACRY/FSOLB/20	Black	20kg	

Acrypol Ancillaries

Prod. Code	Description /Colour	Size	Box. Qty
ACRY/SCRIM/15	Acrypol Scrim	15cm x 20mtr	5

QuartzDek

Highly Durable Coating System

QuartzDek.

High performance, quick and easy waterproof slip resistant surface.

Combining high performance waterproofing (in conjunction with Tech Seal) with a safe slip resistant surface is easy with Acrypol QuartzDek, an anti-slip flooring solution. The secret behind QuartzDek is real quartz granules that are applied over a super-tough, flexible polyurethane waterproof resin, all sealed and bonded together with a final layer of resin.

QuartzDek can be used over concrete, cement, asphalt and even quarry ceramic tiles. It takes just a matter of hours to dry and can be applied without any disruption to the building, allowing occupants to carry on as normal inside. The result improves both the look and waterproofing integrity of balconies, walkways, exterior stairs, risers and even roof gardens.

QuartzDek waterproofing formula means it can be applied in low temperatures and the high BRE rating indicates that it has extremely high anti-slip resistance in both wet and dry conditions.



Prod. Code	Description / Colour	Size	Plt. Qty
ACRY/QRTZ	Clear Resin Base	4kg	72
ACRY/QRTZ20	Clear Resin Base	20kg	20
ACRY/QRTZGRAN/15	Yellow/Light Grey/Black Granules	15kg	30
ACRY/QRTZGRANG/15	Silver Grey/ Light Grey / Black	15kg	30
ACRY/QRTZGRANR/15	Red/Light Grey/ Black	15kg	30



METAL KOTE

Metal-Kote

Single coat product to combat flaking, rusting and peeling metal and plastic coated roofs.

Metal-Kote is a single coat, cold applied solution for renovating and waterproofing failing metal roofs. It can be applied directly in a single coat to combat flaking, rusting and peeling metal and plastic coated roofs, and requires no primer. The formula offers a 100% waterproofing formula and outstanding adhesion that can even fix tears in metal.

The Metal-Kote fast acting formula is also a cost effective solution for bringing an entire roof back to life for just 40% of the cost of replacing it, and without the costly downtime. Metal-Kote's fast-acting protective composition protects and preserves the life, look and performance of buildings.

Fix failed metal roofs in one Metal-Kote.

Prod. Code	Colour	Size	Plt. Qty
ACRY/GWG20	Goosewing Grey 10A05	20ltr	22



Traditional Felts Range

A comprehensive range of SBS, APP and traditional roofing felts. Our products cover all specification options, whether the need is for high performance, torch-on or traditional pour and roll felts.



Cromatorch.

Arcoflex SBS -15°C Cold blend flexibility.

Cromatorch Arcoflex is a traditional bitumen torch on felt. Quick to apply in both wet and dry conditions. For application to concrete, timber and metal deck flat roofs, and can be used as the covering for garages, sheds and flat roof extensions.

Prod. Title	Prod. Code	Weight	Roll Length	Plt. Qty
U/lay Sand 2kg	ECAUSBS/2	32kg	16m x 1m	30
U/lay Glossy Finish 2kg	ECAUSBS/2G	32kg	16m x 1m	30
Cap Sheet Sand 4kg	ECASG/4	32kg	8m x 1m	30
Cap Sheet Grey/Green 4.5kg	ECAGG/4.5	36kg	8m x 1m	25
Cap Sheet Black 4.5kg	ECABR/4.5	36kg	8m x 1m	25



Traditional Felts.

Fibre based / oxidised bitumen.

Prod. Title	Prod. Code	Weight	Roll Length	Plt. Qty
1F U/Slating	B1F/22	22.5kg	15m x 1m	36
Cap Sheet Green Mineral	BCS/36	34kg	10m x 1m	25
Std Bonding Felt	BSB/18	18kg	10m x 1m	42
Std Bonding Felt	BSB/36	36kg	20m x 1m	25
Shedfelt Green	BSF/10	10kg	5m x 1m	63
Shedfelt Green	BSF/20	20kg	10m x 1m	42
Shedfelt Green	BSF/40	40kg	20m x 1m	20
Shedfelt Sand	BSF/7	7kg	5m x 1m	80
Shedfelt Sand	BSF/14	14kg	10m x 1m	48
3B Bonding Felt	C3B/36	36kg	20m x 1m	36
3H Vent Base Layer	C3H/34	34kg	20m x 1m	32



Oxidised Bitumen.

Grade 95/25.

Ideal for bonding traditional roof felts.

Prod. Code	Colour	Size	Plt Qty
NOX/23	Dark Grey	23kg	50
NOX/40	Dark Grey	40kg	12



Cromasol.

Solvent based reflective roof coating.

A high performance reflective paint for use on bituminous surfaces, ideal for use on roofs that are subject to standing rain water.

Prod. Code	Colour	Size	Box Qty
ACS/501	White	5Kg	4
ACSG/501	Grey	5Kg	4
ACS/601	White	20Kg	1
ACSG/602	Grey	20Kg	1



Where it is known that bats are roosting within a roof, 1F bitumen felt is recommended as it is the only roofing felt that does not contain the polypropylene filaments. This felt complies with Building Regulations.

1F U/Slating.

Primarily intended for use as an underslating felt on pitched roofing.

Prod. Code	Size	Weight	Pallet Qty
B1F/22	15m x 1m	22.5kg	36



Protect1F®.

A non breathable roof membrane.

A high performance non breathable roof underslating which gives major benefits over plastic and traditional 1F bitumen based underslating felt.

Prod. Code	Colour	Size	Pallet Qty
TPF/15	Dark Grey	1m x 15m	160
TPF/45	Dark Grey	1m x 45m	56





Vent3® Range

A range of high performance breathable roof underlays for cold and warm roof application.

- BBA certified
- Cold & Warm roof application
- 3 layer spun-bonded membrane
- Clean and easy to use
- High performance & flexibility
- Excellent tensile strength
- No gusting wind noise
- UV stable for up to 3 months
- Excellent nail tear resistance

Vent3® PRO.

Heavyweight performance breathable underlay.

A heavyweight high performance breathable membrane suitable for cold and warm roof applications, providing huge benefits over traditional roof underlays.

Prod. Code	Colour	Size	Pallet Qty
TV3P/50	Green	1m x 50m	56
TV3P/75	Green	1.5m x 50m	48



Vent3®.

High performance breathable underlay.

A high performance breathable membrane ideal for cold and warm roof application.

Prod. Code	Colour	Size	Pallet Qty
TV3/25	Blue	1m x 25m	104
TV3/50	Blue	1m x 50m	54
TV3/75	Blue	1.5m x 50m	54



Vent3® Double Sided Breather Tape.

A modified acrylic, high strength adhesive tape used to create air-tight laps between successive layers of underlay / vapour barrier membrane.

Prod. Code	Size	Box Qty
TC3/TAPE	60mm x 25m	4

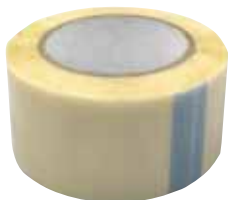

Underlay Support Tray.

A support tray to ensure any underlay is not carried into the gutter, and prevents water ponding behind the fascia. Therefore reducing long term maintenance to the eaves of a building.

Prod. Code	Size	Pack Qty
IUST/1B	235mm x 1.5m	10

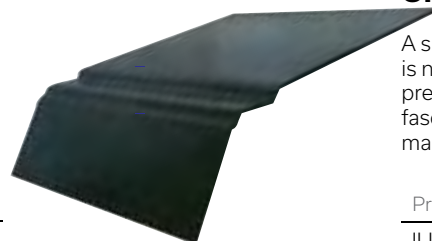



Roofshield Air & Vapour Permeable Pitched Roof Underlay

Roofshield is a low vapour resistant, air permeable and highly watertight breather membrane designed to be fixed beneath tiles and slates as a pitched roof underlay creating a secondary barrier to rain, wind and snow. Roofshield eliminates the need for a vapour control layer or ventilation hardware fitted to the roof. Available through Cromar, in partnership with A Proctor Group.

Roofshield's unique and patented meltblown core enables high levels of airflow and transport of moisture vapour from the roof space, making the formation of condensation virtually impossible and therefore eliminating the occurrence of interstitial condensation in pitched roofs.

Features and Benefits

- UV & Water Resistant
- Low Vapour Resistance
- Air Permeable
- Hydrophobically treated
- No vapour control layer required
- Eliminates low- & high-level ventilation

Prod. Code	Colour	Size	Pallet Qty
IV3CRS/50	Green	1m x 50m	25

Vent3® CLASSIC.

High performance breathable underlay. A breathable roof underlay for cold and warm roof applications which give major benefits over traditional roof underlays.

Prod. Code	Colour	Size	Pallet Qty
TV3C/25	Grey	1m x 25m	104
TV3C/50	Grey	1m x 50m	56
TVC3/75	Grey	1.5m x 50m	56



Vent3® LIGHT.

Lightweight performance breathable underlay. A lightweight breathable roof underlay for cold and warm roof applications, providing major benefits over traditional roof underlays.

Prod. Code	Colour	Size	Pallet Qty
TV3L/25	Grey	1m x 25m	104
TV3L/50	Grey	1m x 50m	56
TV3L/75	Grey	1.5m x 50m	56



Vent3® CLASSIC XTRA.

Taped performance breathable underlay. A taped breathable roof underlay for cold and warm roof applications which give major benefits over traditional roof underlays. The light grey surface prohibits glare.

Prod. Code	Colour	Size	Pallet Qty
IV3C/50	Light Grey	1m x 50m	56

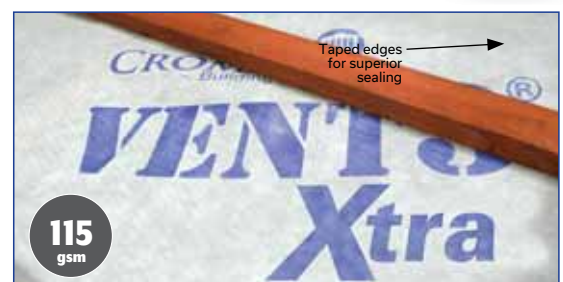

Leadax[®]

CROMAR
Building Products

Leadax Easy FA.

Fully Self-Adhesive Lead replacement.

Leadax Easy FA is the fully self-adhesive lead replacement in the product family Leadax Flashing. Leadax Easy FA has no harmful effects on people's health and the environment. A second generation lead replacement that's very light to use. Leadax Easy FA can easily be applied by hand and only has to be pushed down with a roller very lightly. Leadax Easy FA is extremely thin, yet extremely strong.

NEW	Prod. Code	Colour	Size	Plt. Qty
	KLDE/250	Grey	250mm	165
	KLDE/280	Grey	280mm	99
	KLDE/370	Grey	370mm	66



**FULLY
SELF-ADHESIVE**



**SUSTAINABLE
AND CIRCULAR**



**EXTREMELY
STRONG**



APPLY BY HAND



LIGHTWEIGHT

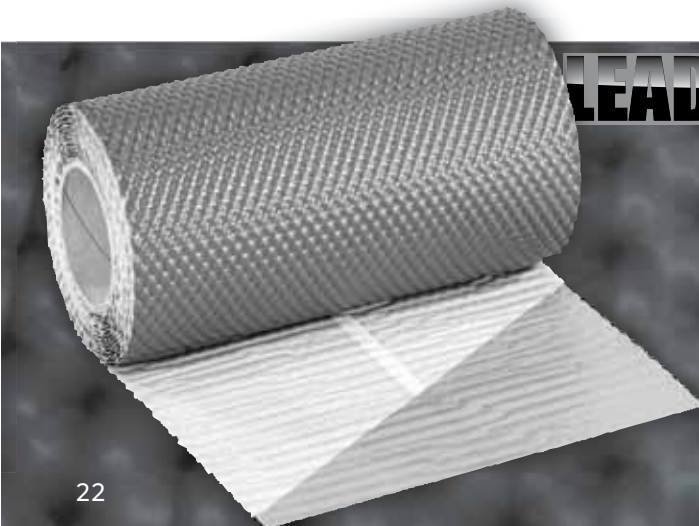

LEAD-FREE PLUS

Lead-Free Plus.
Lightweight & durable.

The THICKER than standard aluminium surface has a unique 3 dimensional pattern, which provides additional strength for all roofing applications.

Typical Installation

- Abutments
- Dormers
- Soakers
- Valleys
- Windows/Rooflights
- Chimneys
- Saddles
- Stepped
- Gutters

Is a high performance, economical aluminium self adhesive flashing suitable for use as an alternative to traditional lead in both flat and pitched roof applications.

Prod. Code	Size	Plt. Qty
KLFP/150	150mm x 5m	288
KLFP/300	300mm x 5m	144
KLFP/450	450mm x 5m	70

Leadax[®]

CROMAR
Building Products

Leadax is the first lead substitute in the world that looks like lead, dresses like lead and is as malleable and as pliable as lead.

Leadax has the same unique properties as traditional water resistant materials such as Lead and Zinc, without having to compromise on quality, flexibility or price. Leadax is applied in exactly the same way as Lead and is equivalent to Code 5.



Flexible



Lightweight



6m Roll Length



No Scrap Value



BBA Certified



Sustainable

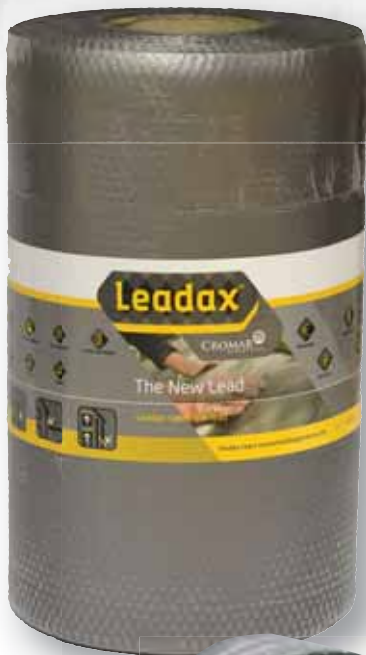

Leadax Original. The New Lead.



Since its launch in 2018 Leadax has grown to be one of the most popular lead alternatives on the market. With numerous benefits over Lead, and other lead replacements, it is the obvious choice.

Prod. Code	Colour	Size	Plt. Qty
KLD/150	Grey	150mm	144
KLD/200	Grey	200mm	120
KLD/250	Grey	250mm	96
KLD/300	Grey	300mm	72
KLD/400	Grey	400mm	48
KLD/450	Grey	450mm	48
KLD/600	Grey	600mm	48
KLD/1000	Grey	1000mm	24



Flashing Tape. Self adhesive lead look tape.

High quality, self adhesive bitumen coated, heavy duty, lead look finish tape for trade use. Available in a wide range of widths in 10mtr long rolls.

Prod. Code	Size	Box Qty
KFB/50N	50mm x 10m	12
KFB/100/N	100mm x 10m	6
KFB/150	150mm x 10m	4
KFB/225	225mm x 10m	2
KFB/300/N	300mm x 10m	2
KFB/450	450mm x 10m	1
KFB/600	600mm x 10m	1



Leadax Fixing Clips. Lead Clips.

For use with above ground masonry, Leadax fixing clips allow you to attach Leadax into masonry joints quickly and easily. Also suitable for use with lead.

Prod. Code	Bag Qty	Box Qty
KLD/CLIP50	50	500 clips (10 bags)



Leadax Rollers. Heavy duty and penny.

Rollers to allow easy moulding of Leadax around roof tiles or difficult profiles.

Prod. Code	Box Qty
KLAD/ROLLER	1
KLAD/PENNYROLL	1



Multi-purpose Scissors. Tough, durable and strong.

High quality, extra tough scissors for cutting Leadax to size quickly and easily.

Prod. Code	Box Qty
KLAD/SCISSORS	1



Leadax Sealant. Hybrid Polymer.

An all purpose hybrid sealant & adhesive for fixing Leadax to the base material or for overlapping. Provides good adhesion to lead & roofing substrates.

Prod. Code	Size	Box Qty
M/LEADAX	290ml	12



Patination Oil. Protective coating.

Specially developed to reduce unsightly staining and provides a pleasing appearance to newly applied lead sheet and flashings.

Prod. Code	Size	Box Qty
MPAT/101	1ltr	10
MPAT/050	500ml	24

PRO RIDGE

Universal Ridge & Hip System



320mm wide ridge roll

- Ensures 75mm coverage at any pitch.
(Wider than any other manufacturer/supplier)
- Perforated roll for additional ventilation.
 - Vapour permeable, wind & rain resistant.
 - Extra wide 25mm butyl adhesive strip.

Stainless Steel Ridge batten fixing straps

100mm Stainless Steel Fixing screws

Self sealing polyamide clamping plate
(No washer required)

Universal ridge union

- Patented ridge union design
- Universal ridge union works with most ridge tiles



ProRidge. Universal kit.

Suitable for ridge and hip application, works with most ridge tiles - the quicker and easier alternative to mortar.

Prod. Code	Size	Plt. Qty
URK/3M	3m	40
URK/5M	5m	40
URK/6M	6m	40



ProRidge Plus. Clay ridge tile kit.

Suitable for use with clay ridge tiles, contains the same components as the Universal ProRidge Kit but with additional ridge tile clamps, screws, ridge unions and union clips.

Prod. Code	Size	Plt. Qty
URK/6MP	6m	40



Ridge Accessory Kit. Universal kit.

A Kit containing the following:
50 x Clamping Plate
50 x 100mm Fixing Screw
50 x Universal Ridge Union

Prod. Code	Box Qty
URK/PACK	1

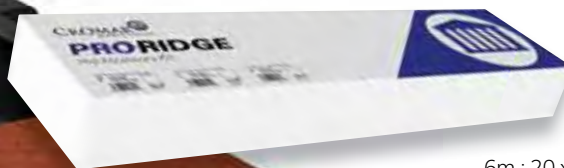

Hip Accessory Kit. Universal kit.

Hip accessory kit, each size containing the following:
6m : 20 x Hip Clips 6 x 1.2m Hip Tray
5m: 17 x Hip Clips 5 x 1.2m Hip Tray
3m: 10 x Hip Clips 3 x 1.2m Hip Tray

Prod. Code	Size	Box Qty
URK/HIP3	3m	1
URK/HIP5	5m	1
URK/HIP	6m	1
URK/TRAY	1.2m tray	20

BS 8612:
Dry Fixed Ridge, Hip and Verges
Systems for Slating and Tiling





GRP Valley Troughs.

The cost effective alternative to lead gutters.

V-Flow valley troughs can be used with clay or concrete tiles or slate roofs, as well as profiled GRP or metal roofs. Options are available for wet or dry fixing (with or without mortar).

- Life expectancy of over 30 years
- Convincing simulation of traditional lead
- Light, easy to handle, install and transport
- Virtually maintenance-free
- Manufacture assured to BS EN ISO 9001
- BBA Certification (No 18/5546)



NEW GDFHVT1 Heritage Valley Trough

Name	Prod. Code	Size	Pack Qty
Standard Valley Trough (Double lap) Slate/Tiles	GSVT1	330mm x 3m	10
Narrow Valley Trough (Single lap tile) Over Batten Fix	GTB13	360mm x 3m	10
Standard Valley Trough (Single lap tile) Over Batten	GTB14	400mm x 3m	10
Standard Valley Trough (Slate or tile) Under Batten	GTF14	400mm x 3m	10
Secret Joint Strip (Bonded in channel)	GJS1	216mm x 3m	10
Abutment Soaker	GAS1	140mm x 3m	10
DF Bonding Strip (Concrete/Clay tile)	GDFBS110	225mm x 3m	10
DF Bonding Strip for use with natural/slate man made	GDFBS70	225mm x 3m	10
Top Closure for use with GDFVTC110	GDFCD110	N/A	10
Eaves Closure Piece for GDFVT70	GFVTC110	N/A	10
DF Valley Trough (Concrete / Clay tile)	GDFVT110	400mm x 3m	10
DF Valley Trough (Natural / Man made slate)	GDFVT70	400mm x 3m	10
90 Degree Top Closure	GDFVTC110	N/A	10
NEW Heritage Valley Trough	GDFHVT1	280mm x 3m	5

GTB13 Narrow Valley Trough



GTB14 Standard Valley Trough



GJS1 Secret Joining Strip



GTF14 Standard Valley Trough



GDFBS70 Dry-fix Bonding Strip



GDFVT110 Dry Valley Trough



GDFBS110 Dry-fix Bonding Strip



GDFVT70 Dry Valley Trough



GSVT1 Standard Valley Trough



Top Closure 90



Eaves Closure



GAS1 Abutment Soaker

PRO Dry Valley & PRO Bonding Strips.

Name	Prod. Code	Size	Pack Qty
Pro Valley Bonding Strip 100mm	GDFBSUB100	225mm x 3m	10
Pro Valley Bonding Strip 70mm	GDFBSUB70	225mm x 3m	10
Pro Valley 105mm	GDFVTUB105	400mm x 3m	10
Pro Valley 55mm	GDFVTUB55	400mm x 3m	10
Pro Valley 80mm	GDFVTUB80	400mm x 3m	10

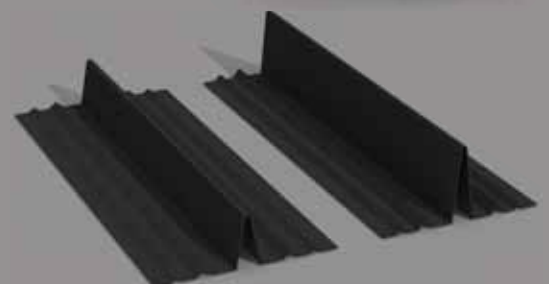

CromaSlate

Reproduction Slate - 100% Recyclable

Specially designed for:

Conservatories

Annexes

Sheds

Garages

Lean-to

Extensions

Premium lightweight thermal roof slate

- **BS476 Part 3 Fire. Ext. S. AC**
- **BRE Wind and Rain**
- **UV Weathering**
- **20 Year Warranty**



CromaSlate.

BS476 Part 3 Fire BRE Wind & Rain
UV Weathering 20 year warranty
15 slates a m² when set at 200mm gauge

Prod. Code	Size	Colour	Pack Qty
R/SLATESG	330mm x 495m	Slate Grey	15



Simple and Easy to Fit



Easy to Cut and Shape



Fits neatly under verges



Angled Ridge & Hip Slate.

225mm visible face, approx. 5 hip ridge per 1m run

Prod. Code	Size	Colour	Box Qty
R/SLATERIDGESG	300mm x 490m	Slate Grey	30



Slate Verge.

The Cromar dry fix slate verge is the perfect solution for mortar free slate verges and provides an all weather solution. Covering the ends of slating battens to provide a traditional appearance, It is designed to fit most natural and man-made slate up to 6mm in thickness and completely eliminates all the long-term problems associated with traditional pointing methods.

- BS8612 compliant
- Easy to handle 2m lengths.
- Quicker to fit than traditional methods
- Improved design for enhanced appearance
- Pre-fitted expansion joints
- Enables thermal movement
- Self-draining
- Protects against wind uplift
- Weatherproof and maintenance free
- Can be fitted in inclement conditions
- No special tools or skills required

Prod. Code	Size	Colour	Box Qty
R/SLATEVERGE	2m	Black	10
R/SLATEVERGE/CON	N/A	Black	10



Angled Ridge Slate.

Prod. Code	Size	Colour	Box Qty
R/SLATERIDGEASG	240mm x 445m	Slate Grey	5/LM

Installation guide can be downloaded from cromar.uk.com





3-in-1 Ventilated Eaves Protector.

The fast and easy way to ventilate and protect at the eaves, consisting of a 1000mm over fascia vent with integrated underlay support tray and eaves comb filler.

Prod. Code	Size	Box Qty
R/OVEP-310	1000x100mm	20



2-in-1 Ventilated Eaves Protector.

Prod. Code	Size	Box Qty
R/OVEP-210	1000x100mm	40



Continuous Rafter Tray.

Allows a constant flow of air between the loft space and outside meaning built-up moisture can escape.

Prod. Code	Size	Box Qty
R/RPV-300	6000X300mm	5
R/RPV-400	6000X400mm	5
R/RPV-600	6000X600mm	5
R/RPV-800	6000X800mm	5



Disc Soffit Vent.

Easy to install circular vent provides eaves ventilation through the soffit for new build or re-roofing.

Prod. Code	Colour	Size	Pack Qty
R/DSV2000B	Brown	2500mm ²	100
R/DSV2000T	Tan	2500mm ²	100
R/DSV2000W	White	2500mm ²	100
R/DSV2000B	Black	2500mm ²	100



5U Eaves Protector Strip.

A support strip to ensure any underlay is not carried into the gutter, and prevents water ponding behind the fascia. Therefore reducing long term maintenance to the eaves of a building.

Prod. Code	Size	Pallet Qty
D5U/330	330mmx16m	-
D5U/15	500mm x 16m	-

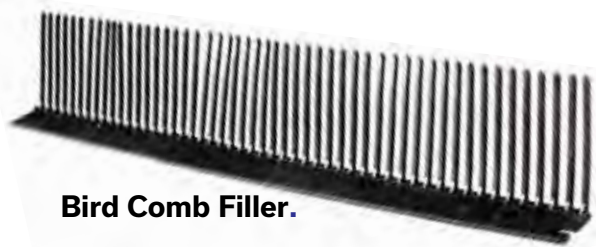

Bird Comb Filler.

A physical barrier that prevents birds, bats and insects entering the roof void between the felt and tiles and causing nesting and infestation problems.

Prod. Code	Size	Box Qty
R/BC-1	1000mm	300

Polythene DPC.

An economical DPC.

Prod. Code	Size	Box Qty
PPY/100	100mm x 30m	9
PPY/150	150mm x 30m	6
PPY/225	225mm x 30m	4
PPY/305	305mm x 30m	3
PPY/450	450mm x 30m	2
PPY/610	600mm x 30m	2

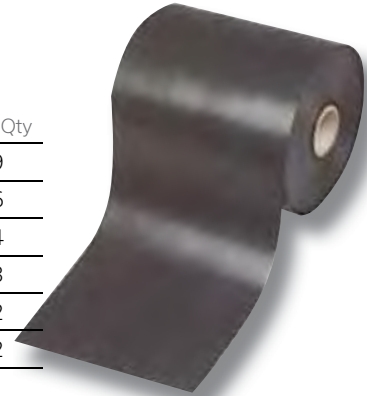

Over Fascia Vent 25mm.

Available in 2 ventilation capacities. Allows an air stream in to the roof void between the felt and fascia board.

Prod. Code	Size	Box Qty
R/OFV25-1000	1000x34mm	50

Over Fascia Vent 10mm.

Available in 2 ventilation capacities. Allows an air stream in to the roof void between the felt and fascia board.

Prod. Code	Size	Box Qty
R/OFV10-1000	1000x23mm	60



Benefits & Features

- **Universally handed**
No need for left and right units
- **Quick fit design**
36 units in under 5 minutes
- **Versatile**
Fits to any type of roof tile
- **High compression**
Roof tiles held firm in strong winds
- **Zero maintenance**
Years of mortar free protection
- **High quality**
Tough and UV stable plastic
- **Mortar-free**
Eaves remains protected but well ventilated

Cromaverge.

Premium universal dry verge.

A premium, universal dry verge system, no need for separate left or right hand verges anymore. With this quick fit design there is no need for using mortar, and roof tiles are held firm even in strong winds.

Prod. Title	Prod. Code	Colour	Plt. Qty
Cromaverge	UR/CROMVERGG	Grey	60
Starter Pack	UR/CROMSTARTG	Grey	200
Cromaverge	UR/CROMVERGB	Brown	60
Starter Pack	UR/CROMSTARTB	Brown	200
Cromaverge	UR/CROMVERGT	Terracotta	60
Starter Pack	UR/CROMSTARTT	Terracotta	200
Cromaverge	UR/CROMVERGBL	Black	60
Starter Pack	UR/CROMSTARTBL	Black	200

Centre Caps Universal.

Rounded and Angled Ridge Caps.

Manufactured from UV stabilised and recyclable polypropylene these centre caps are quick and easy to fix to the apex, with no mortar required. Compatible with Cromaverge and Dry Verge Systems.

Prod. Title	Prod. Code	Colour	Box Qty
Round	UR/CROMCAPRG	Grey	20
Angled	UR/CROMCAPAG	Grey	20
Round	UR/CROMCAPRB	Brown	20
Angled	UR/CROMCAPAB	Brown	20
Round	UR/CROMCAPRT	Terracotta	20
Angled	UR/CROMCAPAT	Terracotta	20
Round	UR/CROMCAPRBL	Black	20
Angled	UR/CROMCAPABL	Black	20

Dry Verge System.

The finishing touches.



Left and right Dry Verge options provide a more traditional aesthetic to roofs but still with the ability to fix quickly and easily and without the use of mortar. The Dry Verge End Caps can be fitted easily to the end of the ridge to prevent water penetration as well as birds and large insects from entering the roof cavity.

Prod. Title	Prod. Code	Colour	Plt. Qty
Starter Pack (end closures)	UR/SP	Grey	200
Dry Verge Left	UR/VERGELEFT	Grey	50
Dry Verge Right	UR/VERGERIGHT	Grey	50
Starter Pack (end closures)	UR/SPB	Brown	200
Dry Verge Left	UR/VERGELEFT3	Brown	50
Dry Verge Right	UR/VERGERIGHT3	Brown	50
Dry Verge Left	UR/VERGELEFT2	Terracotta	50
Dry Verge Right	UR/VERGERIGHT2	Terracotta	50

RENOCOAT

WATER BASED ROOF TILE RENOVATION PAINT

Renocoat.

Water based roof tile renovation paint.

A water based roof tile renovation paint is a quality acrylic coating to give a long lasting protective & decorative finish on slate and concrete roof tiles. RENOCOAT is suitable for use on all exterior roofs and has excellent adhesion properties on porous surfaces.

Prod. Code	Colour	Size	Box Qty
ATRCDB/5	Dark Brown	5kg	4
ATRCDB/20	Dark Brown	20kg	1
ATRCG/5	Slate Grey	5kg	4
ATRCG/20	Slate Grey	20kg	1



Please note: Colours shown against products are simply a representation and are not exact due to limitations of print processes. For exact colours please request samples.

Lowline

Low line tile vents have a minimum pitch of 22.5 degrees

Tile Vent - Flat Suitable for: Russell Galloway, Grampian, Lothian, Moray, Marley Modern, Sandtoft Plain, Redland Stonewold

INTERLOCKING TILE VENTS - FLAT

Prod. Code	Colour	Size	Box Qty
R/TLLV10B	Black	10,000mm ²	12
R/TLLV10BR	Brown	10,000mm ²	12
R/TLLV10G	M/M Grey	10,000mm ²	12
R/TLLV10R	Red	10,000mm ²	12
R/TLLV10T	Terracotta	10,000mm ²	12

Tile Vent - Double Pantile Suitable for: Sandtoft Double Pantile, Redland Double Pantile, Grovebury, Russell Pennine, Marley Mendip

INTERLOCKING TILE VENTS - DPAN

Prod. Code	Colour	Size	Box Qty
R/TLLV10DB	Black	10,000mm ²	12
R/TLLV10DBR	Brown	10,000mm ²	12
R/TLLV10DG	Grey	10,000mm ²	12
R/TLLV10DR	Red	10,000mm ²	12
R/TLLV10DT	Terracotta	10,000mm ²	12

Tile Vent - Profile Suitable for: Redland Brown, Russell Cheviot, Marley Ludlow, Sandtoft Lindum

INTERLOCKING TILE VENTS - PROFILE

Prod. Code	Colour	Size	Box Qty
R/TLLV10PB	Black	10,000mm ²	12
R/TLLV10PBR	Brown	10,000mm ²	12
R/TLLV10PG	Grey	10,000mm ²	12
R/TLLV10PR	Red	10,000mm ²	12
R/TLLV10PT	Terracotta	10,000mm ²	12

Tile Vent - Double Roman Suitable for: Marley Double Roman, Sandtoft Double Roman, Redland 50 Double Roman, Russell Double Roman

INTERLOCKING TILE VENTS - D ROMAN

Prod. Code	Colour	Size	Box Qty
R/TLLV10RB	Black	10,000mm ²	12
R/TLLV10RBR	Brown	10,000mm ²	12
R/TLLV10RG	Grey	10,000mm ²	12
R/TLLV10RR	Red	10,000mm ²	12
R/TLLV10RT	Terracotta	10,000mm ²	12

Universal Tile Ventilators

Designed to be unobtrusive, for use with the majority of manufacturers profiles and colours. Moulded in 'HIPS' with UV stable paint to suit most colours.

Universal Tile Vents

Prod. Code	Colour	Size	Box Qty
R/UTVC10B	Brown	10,000mm ²	6
R/UTVC10T	Terracotta	20,000mm ²	6
R/UTVC20DB	Dark Brown	20,000mm ²	6
R/UTVC20DG	Grey	20,000mm ²	6

Plain Tile Ventilators

Injection moulded offering precision and strength.

Designed to suit all plain clay tiles and can be fitted without cutting the tiling battens. Suitable for pitches of 30° and above.

Plain Tile Vents

Prod. Code	Colour	Size	Box Qty
R/PCV7.5B	Brown	7,500mm ²	20
R/PCV7.5G	Grey	7,500mm ²	20

Tile Cowl

INTERLOCKING TILE VENTS - FLAT

Prod. Code	Colour	Size	Box Qty
R/TCV20B	Black	20,000mm ²	8
R/TCV20BR	Brown	20,000mm ²	8
R/TCV20G	Grey	20,000mm ²	8
R/TCV20R	Red	20,000mm ²	8
R/TCV20T	Terracotta	20,000mm ²	8

INTERLOCKING TILE VENTS - DPAN

Prod. Code	Colour	Size	Box Qty
R/TCV20DB	Black	20,000mm ²	8
R/TCV20DBR	Brown	20,000mm ²	8
R/TCV20DG	Grey	20,000mm ²	8
R/TCV20DR	Red	20,000mm ²	8
R/TCV20DT	Terracotta	20,000mm ²	8

INTERLOCKING TILE VENTS - PROFILE

Prod. Code	Colour	Size	Box Qty
R/TCV20PB	Black	20,000mm ²	8
R/TCV20PBR	Brown	20,000mm ²	8
R/TCV20PG	Grey	20,000mm ²	8
R/TCV20PR	Red	20,000mm ²	8
R/TCV20PT	Terracotta	20,000mm ²	8

INTERLOCKING TILE VENTS - D ROMAN

Prod. Code	Colour	Size	Box Qty
R/TCV20RB	Black	20,000mm ²	8
R/TCV20RBR	Brown	20,000mm ²	8
R/TCV20RG	M/M Grey	20,000mm ²	8
R/TCV20RR	Red	20,000mm ²	8
R/TCV20RT	Terracotta	20,000mm ²	8

Slate Vents

Designed to be both unobtrusive and practical. Available as lowline or cowl in all standard slate sizes. The lowline 10k ventilation area is virtually flat with the sheet, whilst the 10k and 20k cowl type have patented 'anti-splash' sleeves and fly screen protection.

Slate Vents

Prod. Code	Type	Size	Box Qty
R/SLPS10-2	Lowline	10,000mm ² (600x300)	10
R/SLPS10-1	Lowline	10,000mm ² (500x250)	12
R/SCPS10-2	Cowl	10,000mm ² (600x300)	8
R/SCPS10-1	Cowl	10,000mm ² (500x250)	10
R/SCPS20-1	Cowl	20,000mm ² (600x300)	8

Accessories

Prod. Code	Description	Box Qty
R/FHK112	112mm Flexi-tube with clips	50
R/STR/110	110mm Pipe Adapter square to round	100
R/RTR110	110mm Pipe Adapter rectangular to round	50

We are proud to bring you the AlphaChem range, developed with the quality builders merchant and builder in mind - featuring a core range of carefully selected products. All have been designed with eye catching packaging, highlighting our 'Passion for Performance' and our commitment to delivering a top quality product.



SEALANT GUIDE

There are so many different sealants on the market it can become confusing as to which product you should use for which application. So we have simplified our range to show which of the most commonly used substrates the AlphaChem products can be used on.

SUBSTRATE	Bitumen & Asphalt	Ceramics	Concrete	Double Glazed Units	Glass	Metals	Mortar	uPVC	Wood	Wet & Damp Surfaces
DEC CAULK 	Red	Green	Green	Red	Red	Green	Green	Red	Green	Red
Universal Silicone 	Red	Green	Red	Red	Green	Green	Red	Red	Green	Red
Builders Silicone 	Red	Green	Green	Red	Green	Green	Green	Green	Green	Red
All Weather 	Green	Red	Green	Red	Red	Red	Red	Red	Green	Red
Lead Seal 	Red	Green	Green	Red	Green	Green	Green	Green	Green	Red
Roof & Gutter 	Green	Red	Green	Red	Red	Green	Green	Red	Green	Red
Pure 	Red	Green	Red	Red	Green	Green	Red	Green	Green	Red
The Business 	Red	Green	Green	Red	Green	Green	Green	Green	Green	Green
Silicone 800LMN+ 	Red	Green	Green	Red	Green	Green	Red	Green	Green	Red
PU FC40 	Red	Green	Green	Red	Red	Green	Green	Red	Green	Red
PU 25 	Red	Green	Green	Red	Red	Green	Green	Red	Green	Red

Suitable Not Suitable

Silicone 800LMN+.

Low modulus neutral cure silicone.

A premium, high performance, low modulus, neutral cure Alkoxy silicone suitable for expansion joints and perimeter pointing. Fast curing, low meko formula with excellent adhesion to most construction substrates.

Prod. Code	Colour	Size	Box Qty
X1800WE	Pure White	380ml	25
X1800ANTH7016	Anthracite7016	380ml	25
X1800ANTH	Anthracite	380ml	25
X1800BK	Black	380ml	25
X1800BUFF	Buff	380ml	25
X1800BRED	Brick Red	380ml	25
X1800PORTS	Portland Stone	380ml	25
X1800MAG	Magnolia	380ml	25
X1800MG	Mid Grey	380ml	25
X1800CLEAR	Clear	380ml	25

Building Trades Silicone.

The perfect all rounder.

A premium, high performance, neutral cure silicone sealant, exclusively created for weather sealing and glazing applications.

Suitable for adhesion to a wide range of porous and non porous substrates, Building Trades forms a flexible weatherproof seal.

Prod. Code	Colour	Size	Box Qty
X1BUILDWE/25	White	310ml	25
X1BUILDBN/25	Brown	310ml	25
X1BUILDBK/25	Black	310ml	25
X1BUILDDGY/25	Grey	310ml	25
X1BUILDCLEAR/25	Clear	310ml	25
X1BUILDBANTH/25	Anthracite	310ml	25

Polyurethane FC40.

High strength sealant & adhesive.

A fast curing polyurethane sealant used for joints where a highly elastic strong bond is required. Excellent chemical, mechanical and weather resistance. Good adhesion to most building materials. Shore A Hardness: 40.

Prod. Code	Colour	Size	Box Qty
X1PU40WE3	White	300ml	12
X1PU40GY3	Grey	300ml	12
X1PU40BK3	Black	300ml	12
X1PU40WE6	White	600ml	20
X1PU40GY6	Grey	600ml	20
X1PU40BK6	Black	600ml	20

Universal Silicone.

Extra thick, easy tool grade.

High performing, quick curing, universal silicone for general sealing, glazing and sanitary applications.

Provides a permanently water tight and flexible seal. Excellent adhesion to most common non-porous building materials.

Prod. Code	Colour	Size	Box Qty
X1UNIWE	White	295ml	25
X1UNIBK	Black	295ml	25
X1UNIBN	Brown	295ml	25
X1UNICLEAR	Clear	295ml	25
X1UNIGY	Grey	295ml	25

Polyurethane 25.

Low modulus sealant & adhesive.

A fast curing, polyurethane based elastomeric sealant that forms a joint of high elasticity. Has good resistance to weathering and good adhesion to most building materials. Shore A Hardness: 25.

Prod. Code	Colour	Size	Box Qty
X1PU25WE6	White	600ml	20
X1PU25GY6	Grey	600ml	20

Professional Decorators Caulk.

Overpaintable in 1 hour.

A flexible water based filler and sealant that is easy to apply and dries quickly, providing a flexible and smooth finish on interior projects.

Can be overpainted with most emulsion and oil based paints or papered over.

Prod. Code	Colour	Size	Box Qty
X1CLKWE3/25	White	300ml	25
X1CLKWE4	White	380ml	12



PURE.

Anti mould silicone.

A superior quality, waterproof anti-mould 100% silicone suitable for most sanitary sealing and areas of high humidity.

Fast curing, Pure Anti Mould Silicone comes with a 10 year guarantee to keep black mould at bay, ensuring the product stays bright and clean for many years.

Available in 3 popular colours: white, clear and ivory.

Prod. Code	Colour	Size	Box Qty
X1PUREWE/25	White	310ml	25
X1PURECL/25	Clear	310ml	25
X1PUREIV/25	Ivory	310ml	25

All Weather.

For use on bitumen and asphalt.

A high performance bitumen and asphalt adhesive, that can be applied in wet weather applications as well as under water.

Ideal for external weatherproofing and roofline applications as well as gap filling, jointing and bonding.

Remains permanently flexible and comes in a selection of best selling colours.



Prod. Code	Colour	Size	Box Qty
X1WEAWE	White	295ml	12
X1WEABK	Black	295ml	12
X1WEACL	Clear	295ml	12

Lead Sealant.

Solvent free lead sheet & flashing sealant.

Lead Seal is a one part, solvent free adhesive based on the latest polymer technology. It has excellent UV resistance and primerless adhesion to most substrates. It cures to a tough, elastic adhesive. The cured sealant has good abrasion, oil and solvent resistance.

The perfect product for sealing rooflights, conservatories, soffits, glass houses, industrial roofing systems, lead flashing and as an alternative to mortaring lead flashing.



Prod. Code	Colour	Size	Box Qty
MLED-MATE/031	Grey	300ml	25

Roof & Gutter Sealant.

Rubberised oil based sealant.

A roof and gutter sealant specifically designed for repairing leaking gutters, downpipes and flashing.

Also suitable for bedding roofing sheets and felts. Excellent adhesion to most surfaces.



Prod. Code	Colour	Size	Box Qty
MRG/031	Black	310ml	25



Sealant Guns.

Designed to perform.

A range of high quality sealant applicator guns. With reinforced ring and hook end on all 3 in the range. The heavy duty gun provides the next level in applicator quality with a calibrated trigger to give a higher pull ratio.

Prod. Code	Size	Box Qty
X1GUNC4	C4	6
X1GUNHDC4	C4 Heavy Duty	6



MM70.

Ultra strength grab adhesive.

An ultra high strength, fully elastic, hybrid grab adhesive that is 4 times more powerful than a conventional hybrid, therefore eliminating the need for mechanical support in most applications. Provides a strong bond on wet surfaces, in fact in all weather conditions.

Prod. Code	Colour	Size	Box Qty
X2MM70WE3	White	290ml	12
X2MM70WE6	White	600ml	12



Pro Point Gun Kit.

GH-3030C.

Our new Pro Point Gun Kit is a heavy duty mortar and grouting gun that comes as a complete kit including three nozzles (mortar, deep injecting mortar & grouting) along with a mortar mixing turbine. Makes light work of all those brick repointing / patio paving / tile grouting jobs.

- This kit includes:
- 1 x 13" Heavy duty caulking gun.
 - 2 x Black nozzle.
 - 1 x Barrel / Tube.
 - 1 x Glue plate.
 - 1 x Mix paddle.

Prod. Code	Size	Box Qty
X1PROPOINTGUN	C4	1



Foil Applicator Gun.

Professional gun.

A foil applicator gun designed for professional application of 600ml foil packs. Ideal for use with AlphaChem fire rated sealant and Polyurethane FC40 and 25.

Prod. Code	Size	Box Qty
X1GUNFOIL	600ml	1

Joint Backer Rod.

Closed cell polyurethane backer rod for use in expansion joint sealing.

Prod. Code	Colour	Size	Box Qty
X1BACK6	Grey	6mm x 2500m	1
X1BACK10	Grey	10mm x 1150m	1
X1BACK13	Grey	13mm x 750m	1
X1BACK15	Grey	15mm x 550m	1
X1BACK20	Grey	20mm x 350m	1
X1BACK25	Grey	25mm x 200m	1
X1BACK30	Grey	30mm x 160m	1
X1BACK40	Grey	40mm x 270m	1

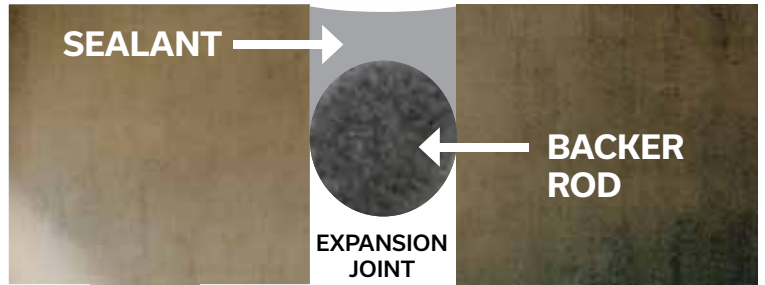

The Business.

Advanced hybrid polymer technology.

The Business is a durable, universal, advanced flexible hybrid sealant and adhesive that sticks and seals almost anything to anything - it is quite simply The Business!

For both internal and external use, in all weather conditions, with excellent adhesion even on wet surfaces. Quick curing, weather resistant, isocyanate, solvent and acid free making it safer to use. Remains fully elastic.

Prod. Code	Colour	Size	Box Qty
X2BUSWE	White	290ml	12
X2BUSCL	Crystal Clear	290ml	12
X2BUSGY	Grey	290ml	12
X2BUSBK	Black	290ml	12
X2BUSWE6	White	600ml	12
X2BUSGY6	Grey	600ml	12
X2BUSBK6	Black	600ml	12



SuperGrip Solvent Free.

A super construction adhesive.

A solvent free, multi purpose construction adhesive offering an instant and tough bond on virtually any porous or non-porous surfaces. Cures to form a superior bond strength. Excellent gap filling properties.

Prod. Code	Colour	Size	Box Qty
X2SUPERG	White	295ml	25

AlphaGrip.

Solvent based instant grab adhesive.

A high quality, fast bonding instant grab adhesive also ideal for gap filling. This solvent based adhesive is the perfect replacement for mechanical fixings in a wide variety of applications whether internal or external with excellent creep and slump resistance.

Ideal for fixing skirting boards, wall battens, gripper rods, laminates and much more. A truly multi purpose adhesive AlphaGrip is suitable for use with a wide variety of building materials.

Prod. Code	Colour	Size	Box Qty
X2ALGRIP	Beige	350ml	12

C4/400ml sealant gun required



AlphaGrip Solvent Free.

Multi purpose grab adhesive.

Solvent free AlphaGrip is a grab adhesive that offers an instant, strong and tough bond on virtually any surface, whether porous or non-porous. Once cured it provides a bond that is hard to break. Excellent gap filling properties.

Prod. Code	Colour	Size	Box Qty
X2SFALGRIP	White	350ml	12



Online Demo Available



<https://youtu.be/Q38lkwY0Cis>



All Trades Mitre Bonding Kit.
Rapid - Strong - Instant Bond.

A handy kit containing aerosol and adhesive, which when used together creates a rapid 10 second, high strength bond. Ideal for bonding wood mitre joints as well as numerous other tasks. Ideal for use on vertical surfaces as it will not drip or slump.



Prod. Code	Size	Box Qty
X2MITREKIT	Kit Containing 200ml aerosol and 50g adhesive	24



Polyurethane 5 Minute.
5 minute rapid cure adhesive.

High quality, solvent free, polyurethane wood bonding adhesive, suitable for a wide range of internal and external applications where a rapid bond is required. Fully waterproof to EN 204 D4, with excellent weathering, aging and gap filling properties, as well as chemical and temperature resistance.

Prod. Code	Colour	Size	Box Qty
X2PU5MIN3	Opaque	300ml	12
X2PU5MIN1	Brown	1000g	6



Polyurethane 30 Minute.
30 minute standard cure adhesive.

High quality, solvent free, polyurethane wood bonding adhesive, suitable for a wide range of internal and external applications where a slightly longer cure time is required. Fully waterproof to EN 204 D4, with excellent weathering, aging and gap filling properties, as well as chemical and temperature resistance.

Prod. Code	Colour	Size	Box Qty
X2PU30MIN3	Opaque	300ml	12
X2PU30MIN1	Brown	1000g	6



Web Spray Bulk Tank.
Hi-tack spray bonding system.

A fast drying, high quality spray adhesive, suitable for permanently bonding a wide variety of substrates including wood, metals, rubber, most plastics, cardboard, polythene and concrete as well as decorative laminates. Available with hose and gun compatible with bulk tank for application.

Prod. Code	Colour	Size	Box Qty
X2WEBTCL	Clear	17kg	1
X2WEBTGUN	-	-	1
X2WEBTHOSE	-	3.66mtr	1



Web Spray Aerosol.
High-tack spray bonding aerosol.

A handy aerosol version of the 17kg tank - with a web like spray that provides a high bond strength on a multitude of substrates. Provides fast and easy hand held application with good temperature resistance.

Prod. Code	Colour	Size	Box Qty
X2WEBT500	White	500ml	12



D3 Wood Adhesive.

Fast curing - sets in just 10 minutes.

High strength, clear drying, water resistant wood adhesive suitable for various wood bonding applications, both internal and external. Fast curing, it sets to provide an impact resistant bond. Conforms to EN 204 (D3) and BSEN 14256 for creep resistance.

Prod. Code	Colour	Size	Box Qty
X2WA1	White /	1ltr	12
X2WA5	Dries Clear	5ltr	4



Spray Contact Adhesive.

High tack - fast bond.

A multi purpose adhesive that will bond to a wide variety of substrates where a high tack and rapid bond is required. Easy to use, quick drying application that provides time saving benefits over spreader applied adhesives.

Prod. Code	Colour	Size	Box Qty
X2SPRAYCON5	N/A	500ml	12



Superglue.

High viscosity adhesive.

A high viscosity superglue ideal for use with the PVCu Activator as well as for general bonding and fixing tasks. Super strong, high viscosity formula.

Prod. Code	Colour	Size	Box Qty
X2GLUE20	-	20gm	10
X2GLUE50	-	50gm	10



PVCu Activator.

Non yellowing formula.

An activator that when used together with high viscosity superglue creates a rapid (10 seconds), high strength bond. Ideal for PVC, PVCu and plastics applications as it will not yellow.

Prod. Code	Colour	Size	Box Qty
X2PVCUACT	N/A	200ml	12



PVA Bond.

Admixture, adhesive & sealer.

A multi use admixture and adhesive that conforms to BS5270, ideal for use as a bonding agent, sealer, primer and admixture for concrete mortars and plasters. High solids.

Prod. Code	Size	Box Qty
X3PVA1	1ltr	12
X3PVA2	2.5ltr	8
X3PVA5	5ltr	4
X3PVA25	25ltr	1



Contract PVA.

Multi-purpose PVA grade.

A contractors grade multi purpose bonding agent, sealer, primer and admixture, adheres to most common building substrates.

Prod. Code	Size	Box Qty
X3CONPVA5	5kg	4
X3CONPVA25	25kg	1



SBR Bond.

Waterproofing, bonding & sealing aid.

A rubber bonding compound with excellent waterproofing qualities in cement, giving increased workability, reduced shrinkage and cracking in repairs and screeding mixes.

Prod. Code	Size	Box Qty
X3SBR5	5ltr	4
X3SBR25	25ltr	1



Concrete Hardener.

Hardens, seals & dustproofs.

A reactive treatment for cement based flooring for new floors or to cure dusting on old, poorly laid floors. Hardens and dustproofs the surface.

Prod. Code	Size	Box Qty
X3CHD5	5ltr	4
X3CHD25	25ltr	1



Mortar Stain Remover.

Powerful acid based formula.

A rapid, concentrated hydrochloric acid based formula for dissolving cement and mortar stains on brickwork, concrete, paving and render. Can also be used for removing efflorescence.

Prod. Code	Size	Box Qty
X3MSR5	5ltr	4



Stabilising Solution.

For friable and chalking surfaces.

A fine polymer emulsion which penetrates dusty, chalky and badly weathered surfaces. Suitable for interior and exterior use.

Prod. Code	Size	Box Qty
MST/501	5ltr	4



Liquid Mortar Tone.

Permanent cement colourant.

Formulated to provide a permanent colour to all types of mortars, rendering, concrete and pointing.

Prod. Code	Colour	Size	Box Qty
MMTB/101F	Black	1kg	15
MMTB/251F	Black	2.5kg	8
MMTB/501F	Black	5kg	4
MMTBR/101F	Brown	1kg	15
MMTBR/251F	Brown	2.5kg	8
MMTBR/501F	Brown	5kg	4
MMTR/101F	Red	1kg	15
MMTR/251F	Red	2.5kg	8
MMTR/501F	Red	5kg	4



Powder Mortar Tone.

Permanent cement colourant.

Formulated to provide a permanent colour to all types of mortar, rendering, concrete and pointing.

Prod. Code	Colour	Size	Box Qty
MPMTB/1	Black	1kg	6
MPMTBR/1	Brown	1kg	6
MPMTR/1	Red	1kg	6
MPMTY/1	Yellow	1kg	6



Fungicidal Wash.

Powerful cleaning formula.

Ideal for treating and removing fungi, algae and lichens on paths, walls, roofs and drives.

Prod. Code	Size	Box Qty
MFW/101	1ltr	12
MFW/251	2.5ltr	8
MFW/501	5ltr	4
MFW/601	25ltr	1



Mortar Plasticiser.
NEW Extra strength formula.

A pink coloured liquid admixture used in brick laying and plastering mortars to aid freeze thaw resistance. Reduces the likelihood of cracking and crazing. Complies with EN934-3 (2009).

Pink colour does not transfer to mortar colour

Prod. Code	Size	Box Qty
X3PLAS5	5ltr	4
X3PLAS25	25ltr	1



Integral Waterproofing.
 Enhanced water resistance.

A liquid additive designed to improve water resistance in concrete and mortar for use in applications where this is a necessity.

Prod. Code	Size	Box Qty
X3INT5	5ltr	4
X3INT25	25ltr	1



More2Mix.
 Highly concentrated plasticiser.

A highly concentrated mortar plasticiser used in bricklaying and plastering mortars to aid workability and freeze thaw resistance. 1ltr will make 25ltr of ready to use product, in a handy bottle that helps to control the dosing of mortar.

Prod. Code	Size	Box Qty
X3MORE1	1ltr	10



3 in 1 Admixture.
 Waterproofs, plasticises & retards.

A 3 in 1 air entraining chloride free liquid admixture that waterproofs, plasticises and retards to assist workability, reduce water penetration and allow larger areas to be covered in one application.

Prod. Code	Size	Box Qty
X33IN15	5ltr	4



Accelerator & Frostproofing.
 Ultimate frost protection.

A liquid admixture designed for aiding the use of cement in cold weather, even at sub zero temperatures, to accelerate setting times and provide frost protection.

Prod. Code	Size	Box Qty
X3ACCEL5	5ltr	4
X3ACCEL25	25ltr	1



Mould Release Oil.
 Improved release performance.

Ensures the quick, clean release of hardened concrete. Can be applied to timber, steel and plastic faced moulds or shutter faces. Provides a uniform hard finish.

Prod. Code	Size	Box Qty
MMRO/501	5ltr	4
MMRO/601	25ltr	1



Water Seal.
Exterior Water Protection.

A micro-porous clear, solvent based waterproofing treatment for porous exterior surfaces such as brickwork, concrete and timber. Imparts superb long last water resistance.

Prod. Code	Size	Box Qty
MXW/101	1ltr	10
MXW/251	2.5ltr	8
MXW/501	5ltr	4
MXW/601	25ltr	1



Brick & Patio Cleaner.

Premium acid based solution.

An acid based solution for high strength removal of cement and mortar stains from brick tiles, earthenware and patios.

Prod. Code	Size	Box Qty
X3BP5	5ltr	4



Block & Paving Sealer.

High quality sealer.

A water based sealer for block paving and porous masonry. This reduces staining, loss of jointing sand and enhances the appearance of the paving.

Prod. Code	Size	Box Qty
MPS/501	5ltr	4
MPS/601	25ltr	1



Line Marker Paint.

Semi-permanent spray applied.

A solvent based, spray applied line marking paint. Quick drying (30 minutes) and semi-permanent it is ideal for contractors for spot marking on roads, factory, warehouse floors etc, as well as grass applications.

Prod. Code	Colour	Size	Box Qty
X3LINEWE	White	700ml	12
X3LINERD	Red	700ml	12
X3LINEYW	Yellow	700ml	12
X3LINEBL	Blue	700ml	12

TOP TIPS

Always warm foam tins to room temperature, in a bucket of warm water, prior to use



Gun Grade Expanding Foam.

High yield formula.

Polyurethane expanding foam, ideal for general construction and home improvement uses. Fills gaps, fixes frames, insulates and can be used as a joint backing material. Excellent adhesion and filling properties.

Prod. Code	Colour	Size	Box Qty
X5FGG/750	Beige	750ml	12



B1 Gun Grade Foam.

High yield fire rated foam.

A high yield, B1, one part, PU expanding foam ideal for filling & insulating joints, gaps and cavities in construction applications. Fire rated according to EN1366-4, conforms to DIN4102-B1 Fire Class.

Prod. Code	Colour	Size	Box Qty
X5FB1GG	Pink	750ml	12



Foam Cleaner.

The ultimate foam cleaner.

The ideal choice for the easy and quick removal of fresh, uncured PU foam from applicator guns and nozzles. Can also be used to clean uncured foam from surfaces, window and door frames.

Prod. Code	Colour	Size	Box Qty
X5FCLEAN	N/A	500ml	12



Hand Held Expanding Foam.

High yield formula.

Polyurethane expanding foam, ideal for general construction and home improvement uses. Fills gaps, fixes frames, insulates and can be used as a joint backing material. Excellent adhesion and filling properties.

Prod. Code	Colour	Size	Box Qty
X5FHH/750	Beige	750ml	12



B1 Hand Held Foam.

High yield fire rated foam.

A high yield, B1, one part, PU expanding foam ideal for filling & insulating joints, gaps and cavities in construction applications. Fire rated according to EN1366-4, conforms to DIN4102-B1 Fire Class.

Prod. Code	Colour	Size	Box Qty
X5FB1HH	Pink	750ml	12



Professional Foam Guns.

Built to perform.

A range of professional quality foam guns ideal for use with AlphaChem Gun Grade foams, allowing for the precise application of the foam.

Prod. Code	Size	Box Qty
X5FGUN	Professional	1
X5FVALG	Value Plus	1

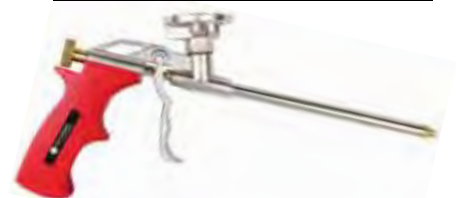

Timber Treatments

A range of professional solvent and water based solutions for wood



Shed & Fence Treat.

Bring timber to life.

A water based decorative timber treatment that brings to life the colour of new or previously treated timber. It is ideal for use on sheds, fences, timber posts and gates. An economical treatment that is harmless to animals and plants. Available in a wide range of popular colours and sizes.

Prod. Code	Colour	Size	Box Qty
LFTD/501	Dark Brown	5ltr	4
LFTD/601	Dark Brown	25ltr	1
LFTG/501	Green	5ltr	4
LFTG/601	Green	25ltr	1
LFTL/501	Light Brown	5ltr	4
LFTL/601	Light Brown	25ltr	1
LFTR/501	Red Cedar	5ltr	4
LFTR/601	Red Cedar	25ltr	1
LFTGR/501	Grey	5ltr	1
LFTGR/601	Grey	25ltr	1



Creotreat.

The original and the best.

Petroleum based timber treatment and stain for all wooden fences and sheds. Available in light brown, dark brown and black.

Prod. Code	Colour	Size	Box Qty
LCTB/401	Black	4ltr	4
LCTB/20	Black	20ltr	1
LCTD/401	Dark Brown	4ltr	4
LCTD/20	Dark Brown	20ltr	1
LCTL/401	Light Brown	4ltr	4
LCTL/20	Light Brown	20ltr	1

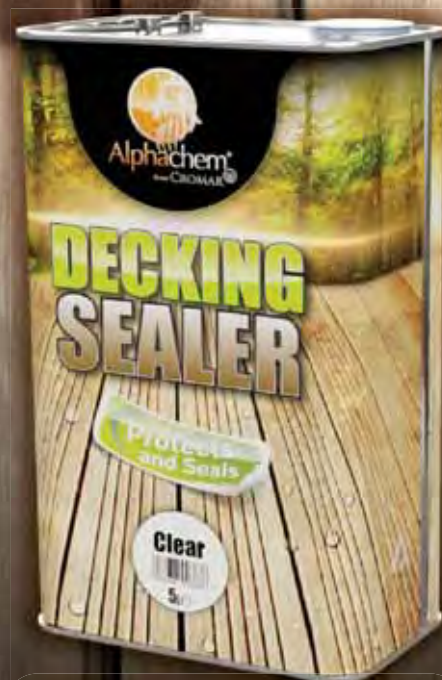

Decking Sealer.

Provides a clear protective barrier.

Protects timber from water damage. Suitable for use on decking and external timbers. Allows wood to breathe and weather naturally over time.

Prod. Code	Colour	Size	Box Qty
LDS/5	Clear	5ltr	4

Coming Soon



MICRO PORUS
Advanced Formulation Technology

3 in 1 Wood Preserver.
Penetrates and protects.

A solvent based Wood Treatment combined with a woodworm and dry rot killer, specially formulated for the Irish market.

Prod. Code	Colour	Size	Box Qty
LWPMP/GREEN1	Green	1ltr	10
LWPMP/GREEN2.5	Green	2.5ltr	6
LWPMP/GREEN5	Green	5ltr	4
LWPMP/GREEN25	Green	25ltr	1
LWPMP/BROWN1	Brown	1ltr	10
LWPMP/BROWN2.5	Brown	2.5ltr	6
LWPMP/BROWN5	Brown	5ltr	4
LWPMP/BROWN25	Brown	25ltr	1
LWPMP/CLEAR1	Clear	1ltr	10
LWPMP/CLEAR2.5	Clear	2.5ltr	6
LWPMP/CLEAR5	Clear	5ltr	4
LWPMP/CLEAR25	Clear	25ltr	1



Wood Treatment.
Penetrates deep into wood.

A solvent based decorative wood treatment ideal for use on fences and sheds. Imparts good water repellence and is available in a wide range of colours.

Prod. Code	Colour	Size	Box Qty
LWC/101	Clear	1ltr	10
LWC/251F	Clear	2.5ltr	6
LWC/501F	Clear	5ltr	4
LWC/601	Clear	25ltr	1
LWD/101	Dark Brown	1ltr	10
LWD/251F	Dark Brown	2.5ltr	6
LWD/501F	Dark Brown	5ltr	4
LWD/601	Dark Brown	25ltr	1
LWG/101	Green	1ltr	10
LWG/251F	Green	2.5ltr	6
LWG/501F	Green	5ltr	4
LWG/601	Green	25ltr	1
LWL/101	Light Brown	1ltr	10
LWL/251F	Light Brown	2.5ltr	6
LWL/501F	Light Brown	5ltr	4
LWL/601	Light Brown	25ltr	1
LWR/101	Red Cedar	1ltr	10
LWR/251F	Red Cedar	2.5ltr	6
LWR/501F	Red Cedar	5ltr	4
LWR/601	Red Cedar	25ltr	1
LWRM/101	Mahogany	1ltr	10
LWRM/251F	Mahogany	2.5ltr	6
LWRM/501F	Mahogany	5ltr	4
LWRM/601	Mahogany	25ltr	1



Universal Dryrot & Woodworm Killer Plus.
Protects timbers against attack.

A solvent based wood treatment combined with a woodworm killer. Contains active ingredients effective against wood boring insects. It penetrates easily into wood and provides an adhesive surface for subsequent finishing paint (top coats).

Prod. Code	Size	Box Qty
LWU/101	1ltr	10
LWU/251	2.5ltr	6
LWU/501	5ltr	4
LWU/601	25ltr	1

**Coverage: 0.5kg per m²
per coat (7.5m² per tub)**



5 easy steps to a waterproof wetroom



1. Apply coating to the junctions between wall to floor and wall to wall corners using a paint brush or short pile roller at a coverage of 0.5kg/sqm.



2. Bed a strip of membrane tape into the coating while it is still wet to strengthen and reinforce the junction points.

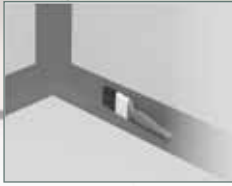

3. Immediately apply a further application of the coating to the membrane tape to encapsulate at coverage rate of 0.5kg/sqm. Allow to dry for 2 hours.



4. Repeat steps 1,2 and 3 to repair and strengthen hairline superficial cracks in the body of the wall or floor. Allow to dry for 2 hours. Also repeat similar for boarded backgrounds along the joint between boards.



5. When dry, apply a uniform coating over the complete wall and floor in a continuous layer at a coverage rate of 0.5kg/sqm using a paint brush or roller as previous. Allow to dry for 2 hours before applying second coat to the same areas at the same coverage rate. Allow 24-48 hours drying time before starting to tile.

Wetroom Tanking Kit

Provides complete moisture protection.

Specifically formulated to provide waterproof protection to wetrooms, domestic bathrooms, kitchens and showers on walls and floors, prior to tiling. Easy to use, brush or roller applied product with no priming required. Each bucket contains full bodied waterproof coating and membrane tape.

NOW WITH ADDED SBR

Prod. Code	Size	Pallet Qty
X2TANKPLUS7	8kg	48

Plasterers Grit Coat.

1st choice for the professional plasterer.

A one coat, ready to use plaster bonding agent with added fine aggregate to provide a key to surfaces prior to plastering. Easy to apply by brush or roller, with an easily identifiable colour to ensure full coverage - the Alpha Orange. Ideal for use on surfaces such as concrete, plaster, and difficult or non-porous substrates.

Prod. Code	Colour	Size	Pallet Qty
X3GRIT5	Orange	5ltr	100
X3GRIT10	Orange	10ltr	48





GRAFTERS

All Trades Wipes

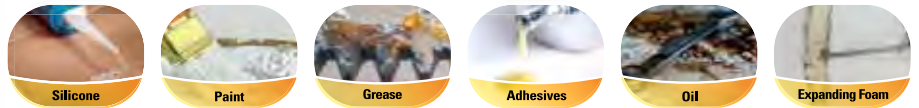

Grafters All Trades Wipes.

Ideal for hands and tools and surfaces.

High performance wipes specifically formulated for cleaning sealants, adhesives, semi-cured paints, PU, foams, oil, grease etc. The ideal cleaning aid for GRAFTERS of ALL TRADES, and to make sure your hands are looked after, even during the most arduous jobs, they also contain a moisturiser.

Prod. Code	Size	Box Qty
X6WIPE100	100 Wipes	6
X6WIPE300	300 Wipes	4



Glass Cleaner.

Smear free cleaner.

A powerful liquid formula designed for easy removal of contaminants on most types of glass, mirrors, plastic and hard surfaces. Provides a smear and static free clean. Removes grime, oily deposits, dust and finger marks.

Prod. Code	Size	Box Qty
X6GLASS1	1ltr	12



PVCu Solvent Cleaner

Heavy duty for ingrained dirt.

A high strength, powerful cleaner for use on PVCu and most other plastics. The perfect way to remove heavily ingrained dirt and make PVCu look brand new again. Ideal for use on PVCu doors, windows, cladding, garden furniture etc.

Prod. Code	Size	Box Qty
X6PVCUS1	1ltr	12



Paper Wipe Rolls.

The essential cleaning aid.

A handy size paper wipe roll, suitable for use with AlphaChem Glass and PVCu Cleaners to enable effective cleaning.

Prod. Code	Size	Box Qty
X6PAPER150	190mm x 150m	6

Visit the Cromar website for all the latest information



- Product pages
- Technical Information
- Latest news
- Downloadable brochures
- Videos

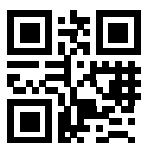

www.cromar.uk.com

Floor Defence - Carpet. Contractors Grade.

A clear, multi-purpose self-adhesive carpet protector. Provides a superior level of protection on all types of carpet and textiles from potentially expensive damage and spills. Reverse wound and easy to apply, no applicator required. Safer alternative to dust sheets.

Prod. Code	Colour	Size	Box Qty
X6DFENDC25		600mm x 25m	6
X6DFENDC50	Clear Transparent Film	600mm x 50m	1
X6DFENDC100		600mm x 100m	1

Floor Defence - Hard Surface. Contractors Grade.

A clear, multi-purpose self-adhesive hard surface protector. Provides a superior level of protection on hard surfaces including timber, hardwood, ceramic, vinyl, laminate, stone floors and worktops, from potentially expensive damage and spills. Reverse wound and easy to apply, no applicator required. Safer alternative to dust sheets.

Prod. Code	Colour	Size	Box Qty
X6DFENDH25	Blue Transparent Film	600mm x 25m	6





Mortar Mix.

General purpose repairs.

A general purpose sand and cement mix ideal for repair jobs, pointing brickwork and general patching internal or externally. Mix together the cement with the bag of sand inside and water and easily make repairs.

Prod. Code	Size	Plt. Qty
X4MORT5	5kg	200



Rapid Set Mortar.

30 minute set mortar.

Ideal for repair situations where a quicker, 30 minutes, is required. This pre-mixed formulation is quick and easy to use, just mix with water and apply.

Prod. Code	Size	Plt. Qty
X4RAPM5	5kg	200



Orange Heavy Duty Tape.

Ultimate performance in all weathers.

An ultra high tack adhesive tape formulated to ensure that one strip is all that's needed. Will adhere to polythene, plaster, brick, concrete, aluminium and steel and will perform in both low and high temperatures.

Prod. Code	Colour	Size	Box Qty
X6ORANGE50	Orange	50mm x 25m	12



Plasterers Scrim.

Made in Europe.

An extra high tack scrim tape for reinforcing plasterboard joints, creating a smooth finish and reducing the risk of cracking on joints.

Prod. Code	Size	Box Qty
X6SCRIM48	48mm x 90m	24



Gaffa Tape.

The perfect all-round tape.

A high quality fabric cloth tape with a rapid adhesive, straight and smooth tear, good tensile strength and excellent moisture resistance.

Prod. Code	Colour	Size	Box Qty
X6GAFSV33	Silver	50mm x 33m	24
X6GAFBK33	Black	50mm x 33m	24



Aluminium Tape.

Fire & water resistant foil tape.

A 30 micron foil tape with an aggressive solvent acrylic adhesive protected by an easy release liner. Tested to BS476 part 6 & 7 standards and meets class 1 and class 0 fire regulations.

Prod. Code	Colour	Size	Box Qty
X6ALUM50	Silver	50mm x 33m	24
X6ALUM100	Silver	100mm x 33m	12

POINT OF SALE

We have numerous point of sale options available for customers, ranging from gate banners to roller banners, application guides and leaflets. An example of what is available can be found below.

Please email: marketing@cromar.uk.com for orders



Product Catalogue - A4



ACRYPOL Range Guide - A4



Flexiglass Usage Guide - A4



GRP Install Guide - A5



Flexiglass Install Guide - A5

Catalogues
 If you find yourself needing more copies of this catalogue, no problem, add some onto your next order using the product code: **CATALOGUE**



ACRYPOL Poster - A3



ACRYPOL Poster - A3



GRP Trim Poster - A3



Flexiglass Roller Banner



GRP Roller Banner

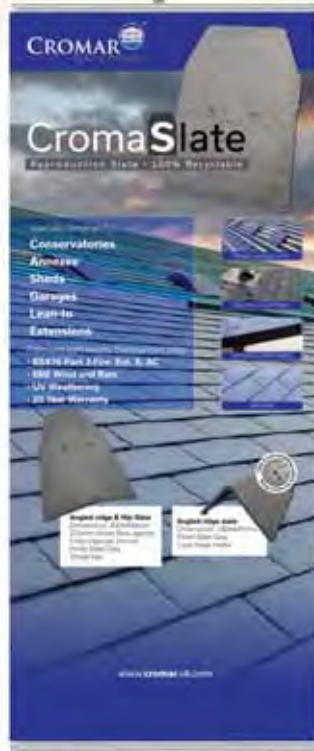

Cromaslate Roller Banner



Hydrosil Roller Banner

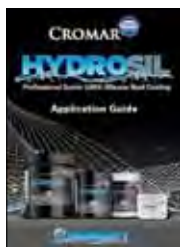

Hydrosil Application Guide - A5



Leadax Easy FA Booklet - A5



Cromaslate Install Guide - A5



Leadax Flyer - A5



Cromaslate Range Flyer - A5



Slate Verge Flyer - A5



GRP Roller Banner



GRP Roller Banner



GRP Roller Banner



Cromar/AlphaChem Merchant Display Stand



Acrypol Display Stand



Air Freshener various designs



Leadax Monitor - A4



Hydrosil Gate Banner - 6' x 2'



PRO GRP Gate Banner - 6' x 2'



AlphaChem Gate Banner - 6' x 2'



Cromar Gate Banner - 6' x 2'



Cromaslate Gate Banner - 6' x 2'



Flexiglass Gate Banner - 6' x 2'



Cromapol Gate Banner - 6' x 2'



Leadax Gate Banner - 6' x 2'

IMPORTANT INFORMATION

Images

The link below will take you to our image portal where you can download our product images, logos and POS.

www.cromarbuildingproducts.com/download-media-page/

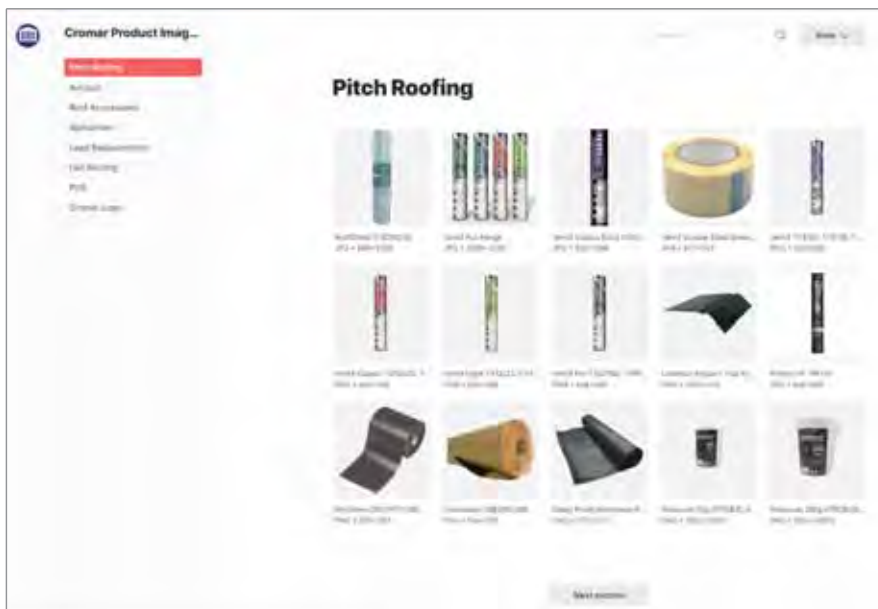

Datasheets

All of our Technical and Safety Datasheets can be found on our website and are available for download.



SDS

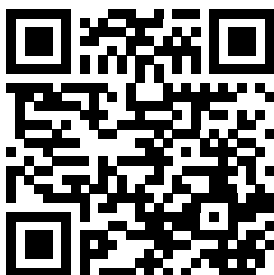

TDS

FAQ

If you have a question about one of our products, we can guarantee that someone has asked it before. So, we now have a Frequently Asked Questions page on our website that is regularly updated by our team.

For products such as PRO GRP, Flexiglass and Hydrosil you can also refer to the relevant product application guide for detailed instructions and coverage / dosing rates.

Technical Queries

If you have a technical question on any of the products in this catalogue please refer to the Contacts section of the website:

www.cromarbuildingproducts.com/contact

For more information and sales support please contact us on:

Tel: 01977 663 133

Fax: 01977 662 186

Email: sales@cromar.uk.com

Customers Services:

CustomerServices@cromar.uk.com

Cromar's terms and conditions can be found on website www.cromar.uk.com



[/cromarbuildingproductsltd](#)



[/cromarbuildingproducts](#)



[/CromarProducts](#)



[/company/cromarbuildingproducts](#)

Cromar Building Products

Units 1, 3, 4, 5 Northside Industrial Estate, Whitley Bridge, DN14 0GH

Tel: 01977 663 133 Fax: 01977 662 186 Web: www.cromar.uk.com Email: sales@cromar.uk.com

Rev.7.8